

---

**PROJECT:** Merced College Greenhouse Complex

**OWNER:** Merced College  
3600 M Street  
Merced CA, 95348

**ENGINEER:** Blair, Church & Flynn  
Attention: Zachary Hockett  
Kyle Lawson

**BID NO:** 2024-08  
**BCF PROJECT NO.** 222-0314

---

It will be the responsibility of the General Contractor to submit the information contained in this addendum to all its subcontractors and suppliers. Acknowledge receipt of this Addendum in the space provided on the Bid Form. Failure to do so may subject Bidder to disqualification. The following additions, deletions, and revisions to the Drawings and Project Manual are hereby made and do become a part of these Contract Documents.

---

## TABLE OF CONTENTS

---

### CHANGES TO BIDDING AND CONTRACT REQUIREMENTS

*AD1-1: Specification Clarification*

*AD1-2: Deductive Alternates*

## ATTACHMENTS

---

*Specification 01 11 00 Summary of Work*  
*C104 Site Plan & Horizontal Control*

## **CHANGES TO BIDDING AND CONTRACT REQUIREMENTS**

### **AD1-1: Specification Clarification**

- 1.03 of Specification 01 11 00 – Summary of Work has been modified

### **AD1-2: Deductive Alternates**

1. Deductive Alternate 1 has been added to sheet C104
2. Deductive Alternate 2 has been added to sheet C104

## SECTION 01 11 00 - SUMMARY OF WORK

### PART 1 – GENERAL

#### 1.01 RELATED DOCUMENTS:

- A. Drawings and general provisions of Contract, including General Conditions and Supplemental General Conditions and other Division 01 General Requirements, apply to this Section.

#### 1.02 PROJECT DESCRIPTION:

- A. Project Name: Merced College Greenhouse Complex
- B. Project Location: Merced Community College District, 3600 M Street, Merced California, 95348
- C. Owner: Merced Community College District
- D. Civil Engineer: Blair, Church & Flynn, 451 Clovis Ave, Suite 200 Clovis, CA 93612
- E. Electrical Engineer: Thoma Engineering, 3562 Emplo St., San Luis Obispo, CA 93406

#### 1.03 THE WORK CONSISTS OF:

1

- A. Installation of owner furnished shade structure, three (3) greenhouse buildings, and metal storage building.
- B. Three (3) storage containers and two (2) loafing sheds are existing on site and will be relocated by the owner. The loafing sheds shall be achored to the slab by the owner. The contractor shall be responsible for the concrete slabs, electrical scope, utility scope, and all other scope associated with the storage containers and loafing sheds.
- C. Construction of material storage yard.
- D. Utility improvements including gas, electrical, and domestic water to serve the proposed greenhouse buildings.
- E. Site improvements including concrete sidewalk and stabilized decomposed granite surfacing and exterior lighting.
- F. Grading and storm drain improvements.

#### 1.04 CONTRACT

- A. The Work will be constructed under a single general construction contract.

#### 1.05 CONTRACTOR'S USE OF PREMISES

- A. Contractor may be required to share use of Project site during construction period with contractors performing work under other contracts for construction of the overall Project and shall coordinate construction operations with those of other contractors. Designated areas will be established for the shared use of the Contractor, and contractors performing work under other contracts. Contractor's use of premises is limited only by Owner's right to perform work or to obtain other contractors on portions of the Project.
- B. Confine operations to areas within Contract limits indicated. Portions of the site beyond areas in which construction operations are indicated are not to be disturbed.
- C. Keep driveways and entrances serving the premises clear and available to the Owner and the public at all times. The Contractor is to provide and maintain free and clear access to areas throughout the site for emergency services. Do not use these areas for parking or storage of materials. Schedule deliveries to minimize space and time requirements for storage of materials and equipment on site.
- D. Repair and replace damaged existing site improvements to remain such as curbs, parking lot paving, roadways, site vegetation, turfgrass, and utilities.

#### 1.06 WORK UNDER OTHER CONTRACTS

- A. Contractor shall cooperate fully with separate contractors so work on those contracts may be carried out smoothly, without interfering with or delaying work of those contracts or work under this Agreement.

#### 1.07 COORDINATION OF SYSTEM START-UP

- A. Coordinate with Division 01 Specifications

#### PART 2 – PRODUCTS (NOT USED)

#### PART 3 – EXECUTION (NOT USED)

END OF SECTION 01 11 00



## GENERAL HORIZONTAL CONTROL NOTES:

- ALIGNMENT OF THE SITE LAYOUT GRID IS BASED ON AN ASSUMED COORDINATE SYSTEM.
- SITE LAYOUT POINT 100 IS A BRASS CAP STAMPED "SURVEY MARK"; FLUSH ON CURB; SOUTH SIDE OF UNIVERSITY DRIVE, APPROXIMATELY 75' EAST OF DRIVE APPROACH, APPROXIMATELY 51' SOUTHEAST OF WATER VALVE, APPROXIMATELY 17.5' SOUTHWEST OF WATER VALVE.
- SITE LAYOUT POINT 101 IS A CHISELED "X" LOCATED IN CONCRETE SIDEWALK 58' SOUTHWEST OF THE SOUTHWEST CORNER OF EXISTING STREET LIGHT.
- SITE LAYOUT POINT 102 IS A NAIL AND TIN LOCATED APPROXIMATELY 31' NORTHWEST OF THE SOUTHWEST CORNER OF EXISTING 4" WIRE FENCE.
- DIMENSIONS AND POINTS ARE TO CENTER OF FENCE POSTS, FACE OF BUILDINGS, TOP FACE OF CURB, OR EDGE OF CONCRETE, UNLESS SHOWN OTHERWISE.

## HORIZONTAL CONTROL LEGEND:

100 LCP	LAYOUT COORDINATE POINT
100 SLP	SITE LAYOUT POINT
100 BLP	BUILDING LAYOUT POINT
CC	CORNER CONCRETE
FP	FENCE POST
GR	DRAIN INLET GRATE
	STORM DRAIN INLET, SEE GRADING AND DRAINAGE PLAN

## SITE LEGEND:

[A/X101]	[DETAIL DESIGNATION / SHEET LOCATION]
[LIMITS OF STANDARD DUTY CONCRETE IMPROVEMENTS]	[LIMITS OF STANDARD DUTY CONCRETE IMPROVEMENTS]
[LIMITS OF ASPHALTIC CONCRETE PAVEMENT STRUCTURAL SECTION]	[LIMITS OF ASPHALTIC CONCRETE PAVEMENT STRUCTURAL SECTION]
[LIMITS OF DECOMPOSED GRANITE]	[LIMITS OF DECOMPOSED GRANITE]
[LIMITS OF DETECTABLE WARNINGS PER DETAIL [G/X100]]	[LIMITS OF DETECTABLE WARNINGS PER DETAIL [G/X100]]
1	CONCRETE SIDEWALK PER DETAIL [A/X100]
2	4" STABILIZED DECOMPOSED GRANITE PER [B/X100]
3	CONCRETE MOWSTRIP PER DETAIL [C/X100]
4	BARBED WIRE WITH ELECTRIC DETERRENT WIRE FENCE TO MATCH EXISTING FENCE
6	ACCESSIBLE CURB RAMP PER DETAIL [F/X100]
7	HEAVY DUTY ASPHALT CONCRETE PAVEMENT PER DETAIL [J/X100]
8	ASPHALT CONCRETE PLUG PER DETAIL [J/X100]
9	MATERIAL STORAGE BAY CONCRETE RETAINING WALL PER DETAIL [K/X100]
10	CONTRACTOR TO VERIFY THAT PARKING STALL SIGNAGE MEETS THE MINIMUM REQUIREMENTS OF DETAIL [A/C100]. IF SIGNAGE DOES NOT MEET THE MINIMUM REQUIREMENTS, CONTRACTOR SHALL INSTALL NEW SIGNAGE ON EXISTING POST PER DETAIL [A/C100]
11	CONTRACTOR TO VERIFY THAT TOW AWAY SIGNAGE MEETS THE MINIMUM REQUIREMENTS OF DETAIL [B/C100]. IF SIGNAGE DOES NOT MEET THE MINIMUM REQUIREMENTS, CONTRACTOR SHALL INSTALL NEW SIGNAGE ON EXISTING POST PER DETAIL [B/C100]
12	ELECTRICAL EQUIPMENT PAD, SEE ELECTRICAL PLANS FOR FURTHER INFORMATION

## SITE NOTES:

- ALL CONCRETE MOWSTRIPS, RAMP AND SIDEWALKS SHALL HAVE WEAKENED PLANE JOINTS AT 15 FEET MAXIMUM ON CENTER AND ONE HALF INCH EXPANSION JOINTS AT 45 FEET MAXIMUM ON CENTER PER DETAIL [A/X100].
- INSTALL DOWELED CONNECTION AT JOINT OF NEW CONCRETE TO EXISTING CONCRETE PER DETAIL [D/X100].
- NO CONCRETE MAY BE POURED UNTIL THE FORMS HAVE BEEN REVIEWED AND APPROVED BY THE PROJECT INSPECTOR.
- ALL BURIED METALLIC OBJECTS SHALL HAVE A PROTECTIVE COATING OR BE WRAPPED WITH APPROVED PROTECTIVE WRAP.
- ADJUST EXISTING SPRINKLER HEADS AND LATERAL LINES AS REQUIRED FOR NEW IMPROVEMENTS.
- DIMENSIONS ARE TO CENTER OF FENCE POSTS, FACE OF BUILDINGS, FACE OF WALLS OR EDGE OF CONCRETE.
- 2 WORKING DAYS BEFORE COMMENCING EXCAVATION OPERATIONS WITHIN THE STREET RIGHT-OF-WAY AND/OR UTILITY EASEMENTS, ALL EXISTING UNDERGROUND FACILITIES SHALL HAVE BEEN LOCATED BY UNDERGROUND SERVICES ALERT (USA). CALL 1-800-642-2444.
- ANY SURVEY MONUMENTS WITHIN THE AREA OF CONSTRUCTION SHALL BE PRESERVED OR RESET BY A PERSON LICENSED TO PRACTICE LAND SURVEYING IN THE STATE OF CALIFORNIA.

## DEDUCTIVE ALTERNATES:

- CONCRETE & UTILITY SCOPE REDUCTION  
A. REMOVE CONCRETE SIDEWALK FROM SCOPE THAT IS SHOWN IN GREEN. MAINTAIN CONCRETE SIDEWALK SHOWN IN RED.  
B. REMOVE TRENCH FROM SCOPE  
DEDUCTIVE ALTERNATE 1 NOTE: IF DEDUCTIVE ALTERNATE IS ACCEPTED, CONTRACTOR SHALL MAINTAIN DRAINAGE PATTERNS AS IDENTIFIED IN THE DESIGN DOCUMENTS
- FENCE SCOPE REDUCTION  
REMOVE FENCE INSTALLATION FROM SCOPE

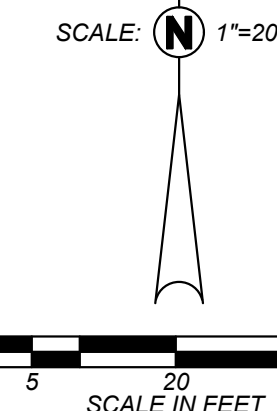

SCALE: 1"=20'

SCALE IN FEET

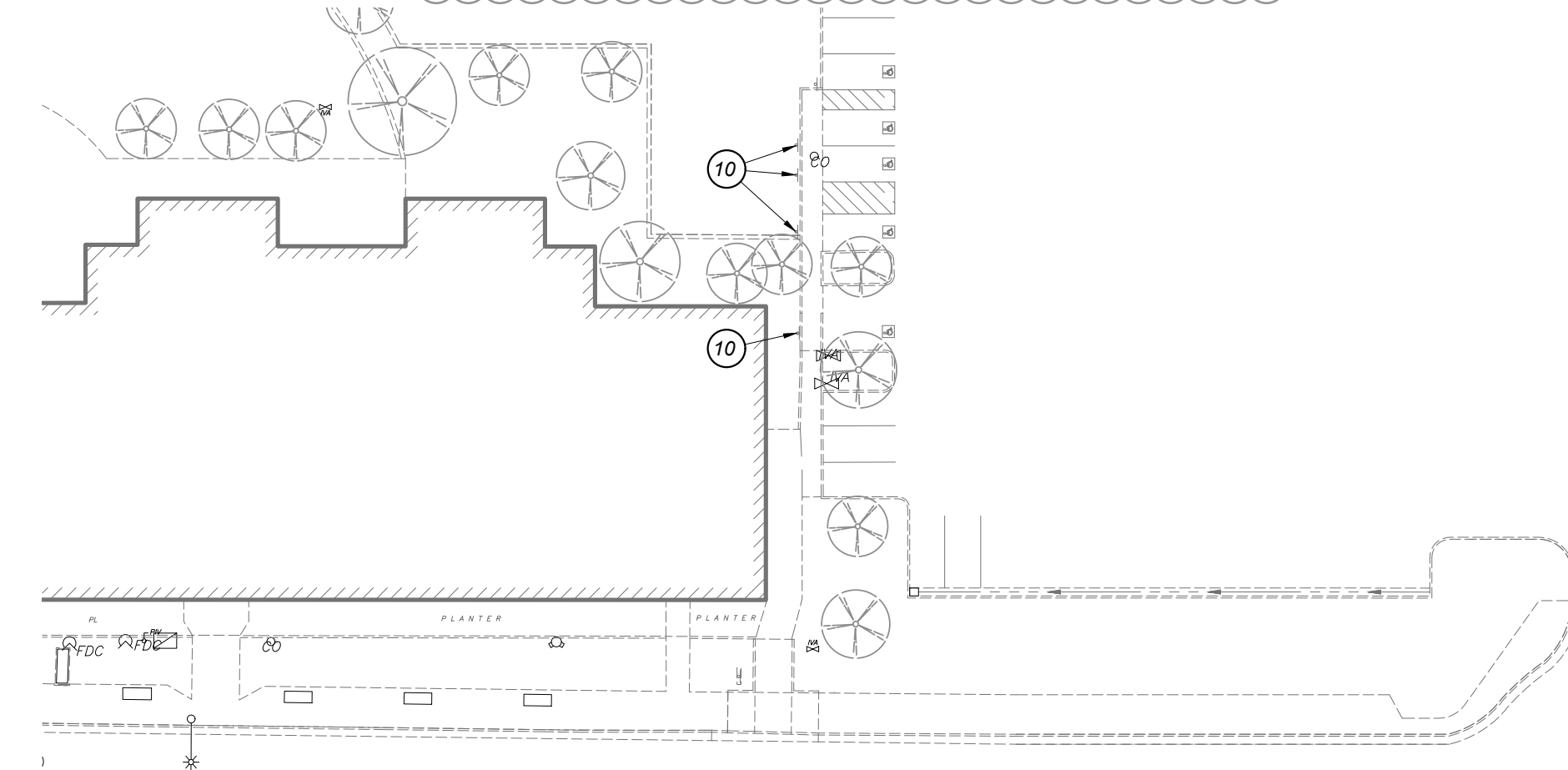

PARKING LOT A

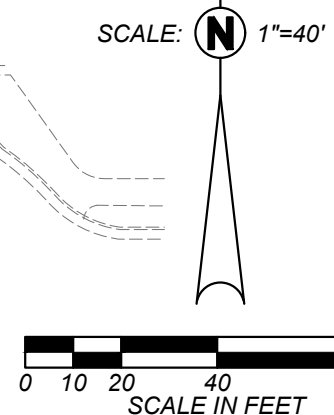

SCALE: 1"=40'

SCALE IN FEET

NORTHING EASTING TABLE				
POINT	NORTHING	EASTING	ABV	DESCRIPTION
100	1945050.08	6569563.59	SLP	SITE LAYOUT POINT
101	1945052.16	6569403.02	SLP	SITE LAYOUT POINT
102	1945464.64	6569333.71	SLP	SITE LAYOUT POINT
103	1945438.69	6569492.58	BLP	BUILDING LAYOUT POINT
104	1945438.69	6569488.58	BLP	BUILDING LAYOUT POINT
105	1945438.69	6569458.57	BLP	BUILDING LAYOUT POINT
106	1945438.69	6569434.58	BLP	BUILDING LAYOUT POINT
107	1945438.69	6569415.59	BLP	BUILDING LAYOUT POINT
108	1945438.69	6569373.58	BLP	BUILDING LAYOUT POINT
109	1945508.90	6569483.58	BLP	BUILDING LAYOUT POINT
110	1945508.90	6569435.58	BLP	BUILDING LAYOUT POINT
111	1945566.69	6569449.60	BLP	BUILDING LAYOUT POINT
112	1945566.69	6569474.60	BLP	BUILDING LAYOUT POINT
113	1945564.69	6569516.00	BLP	BUILDING LAYOUT POINT
114	1945564.69	6569528.00	BLP	BUILDING LAYOUT POINT
115	1945564.69	6569555.97	BLP	BUILDING LAYOUT POINT
116	1945564.69	6569567.97	BLP	BUILDING LAYOUT POINT
1001	1945427.69	6569573.60	CC	CORNER CONCRETE
1004	1945571.19	6569426.59	CC	CORNER CONCRETE
1005	1945556.69	6569434.58	CC	CORNER CONCRETE

POINT	NORTHING	EASTING	ABV	DESCRIPTION
1006	1945566.69	6569483.61	CC	CORNER CONCRETE
1007	1945566.69	6569507.61	CC	CORNER CONCRETE
1008	1945564.69	6569547.60	CC	CORNER CONCRETE
1009	1945572.19	6569442.58	CC	CORNER CONCRETE
1012	1945548.69	6569500.60	CC	CORNER CONCRETE
1017	1945607.85	6569372.58	CC	CORNER CONCRETE
1018	1945579.19	6569434.58	CC	CORNER CONCRETE
1028	1945621.13	6569700.85	FP	FENCE POST
1029	1945450.69	6569424.65	GR	DRAIN INLET GRATE
1030	1945481.32	6569424.65	GR	DRAIN INLET GRATE
1031	1945592.69	6569434.58	GR	DRAIN INLET GRATE
1032	1945586.69	6569488.67	GR	DRAIN INLET GRATE
1033	1945510.69	6569491.85	GR	DRAIN INLET GRATE
1034	1945536.19	6569491.85	GR	DRAIN INLET GRATE
1035	1945475.44	6569497.09	GR	DRAIN INLET GRATE
1036	1945450.94	6569497.09	GR	DRAIN INLET GRATE
1037	1945520.19	6569338.53	GR	DRAIN INLET GRATE
1038	1945585.69	6569542.04	GR	DRAIN INLET GRATE
1039	1945450.94	6569463.58	GR	DRAIN INLET GRATE
1040	1945475.44	6569463.58	GR	DRAIN INLET GRATE

POINT	NORTHING	EASTING	ABV	DESCRIPTION
1041	1945498.69	6569463.59	GR	DRAIN INLET GRATE
1042	1945525.73	6569424.65	GR	DRAIN INLET GRATE
1043	1945553.31	6569424.65	GR	DRAIN INLET GRATE
1045	1945422.69	6569428.14	GR	DRAIN INLET GRATE

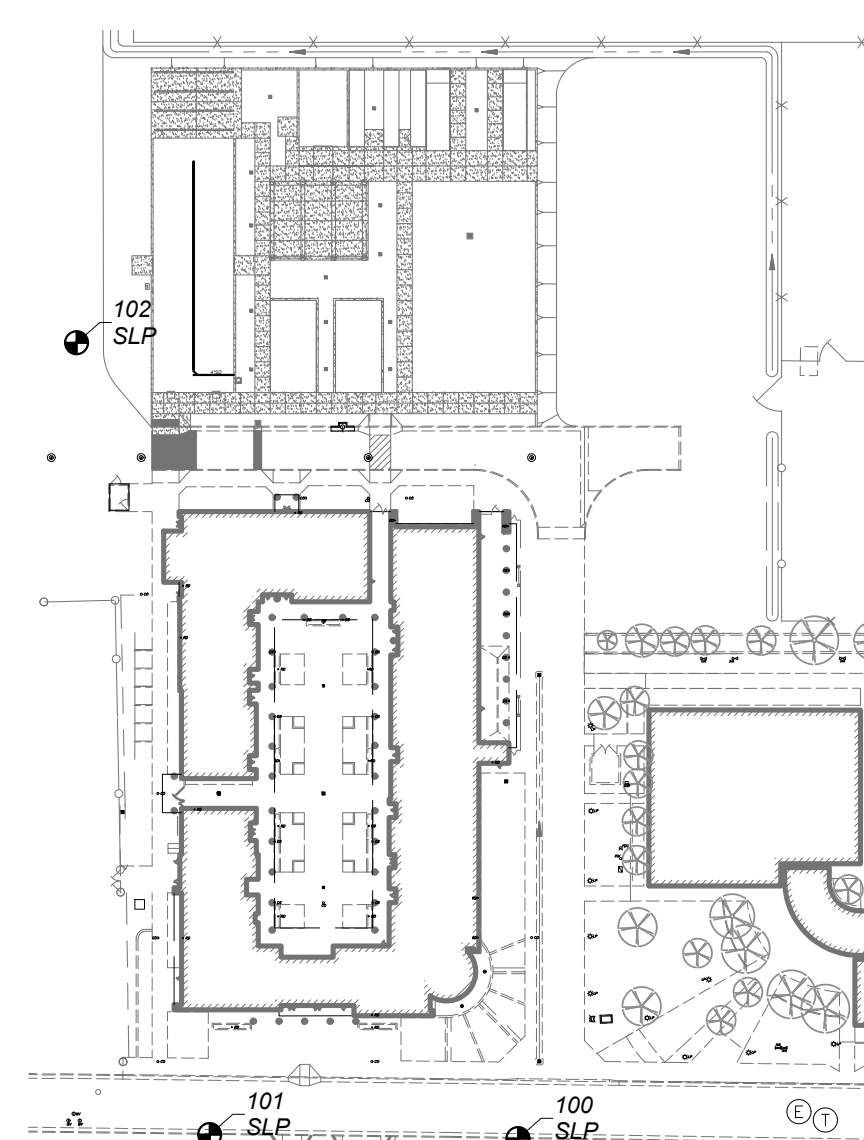

SITE LAYOUT POINTS



Know what's below.  
Call before you dig.

Blair,  
Church & Flynn  
CONSULTING ENGINEERS

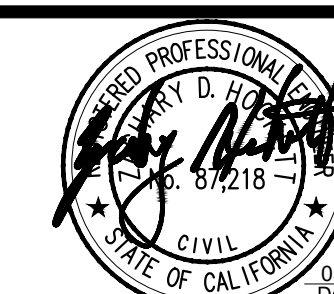

CONSULTANT  
Blair, Church & Flynn  
Consulting Engineers  
455 Clovis Avenue,  
Suite 200  
Clovis, California 93612  
Tel (559) 326-1400  
Fax (559) 326-1500

REF. & REV.  
BIDDING  
ADDENDUM 01

MERCED COLLEGE GREENHOUSE COMPLEX  
GREENHOUSE COMPLEX  
SITE PLAN & HORIZONTAL  
CONTROL  
CONST. DOCUMENTS  
C104

DR. BY: AH  
CH. BY: PH  
DATE: 03/01/2024  
SCALE AS NOTED