

MERCED COMMUNITY COLLEGE DISTRICT

2023 ANNUAL SECURITY REPORT and CRIME STATISTICS

2020/2021/2022

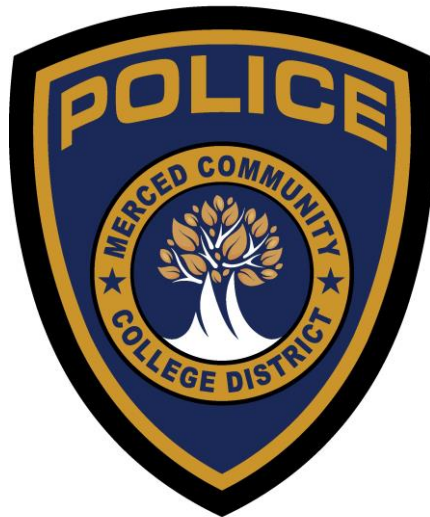

MERCED COMMUNITY COLLEGE DISTRICT
CAMPUS POLICE SERVICES, SAFETY AND SECURITY DEPARTMENT

3600 M STREET
MERCED, CA 95340
(209) 386-6600

Merced Community College District Police Department is responsible for the publication of this report in accordance with the Jeanne Clery Act.

This report is provided pursuant to the Jeanne Clery Disclosure of Campus Security Policy and Campus Crime Statistics Act and the Higher Education Opportunity Act (Public Law 110-315) as per the Higher Education Act of 1965, as amended, and the Violence Against Women Reauthorization Act (VAWA) under Campus Sexual Violence Act (SaVE Act) provision, Section 304.

Table of Contents

Message from the Director of Law Enforcement	5
Merced Community College District Campus Police	
Mission Statement	6
Department Information	6
Campus Law Enforcement Authority	7
Contact Information	8
Uniform Campus Crime Report	9
Students' Right to Know	10
Crime Reporting Procedures	11
Parking Information	12
Security Awareness and Crime Prevention	14
Timely Warning Policy	15
Access and Security to Campus Facilities	16
Escort Service	17
Alcohol & Drug Abuse and Weapons Policies	18
Sexual Assaults and Sexual Offender Registration Laws	19
Megan's Law	23
Marsy's Law	25
Policy on Workplace Violence	27
Hate Crimes	27
Emergency Response and Evaluation Policy	28
Emergency Procedure: Fire	29
Emergency Procedure: Earthquake	30
Emergency Procedure: Shooting/Sniper/Violent Armed Individual	31
First Aid Instructions	33

Annual Disclosure of Crime Statistics	35
Geographical Location	35
Reportable Crimes and Definition & Information	36
Merced and BRC Crime Statistics: 2020/2021/2022	
Criminal Offenses	40
Hate Crimes	42
VAWA	54
Special Category Arrests & Disciplinary Actions	56
Unfound Crimes	58
Los Banos and Welding Shop Crime Statistics: 2020/2021/2022	
Criminal Offenses	61
Hate Crimes	63
VAWA	71
Special Category Arrests & Disciplinary Actions	73
Unfound Crimes	75
Merced Community College District Maps	
District Area Maps	77
Merced Campus Maps	78
Los Banos Campus	79

A Message from the Director of Law Enforcement

Welcome to Merced Community College

The Merced Community College District Campus Police Department is proud to welcome all students, faculty, staff, guests, and visitors to the Merced Community College District campuses. As members of the college community, Campus Police is dedicated to the preservation of public safety by providing innovative and progressive service and shares the responsibility of ensuring and maintaining a safe, healthy, and engaging educational learning environment where everyone can enjoy the challenges and rewards of obtaining or providing an education free from fear, harassment, or discrimination in partnership with the community. The safety and wellbeing of all members of the college community is the primary concern and responsibility of the officers and staff of Merced College Campus Police. Cameras are in place throughout campus to assist with District and public safety.

The Merced Community College District Campus Police is a California Commission on Police Officers Standards and Training (P.O.S.T.) certified police agency with highly trained officers and support personnel. We are committed to the highest standards of professionalism and service. Campus Police strives to provide an atmosphere of safety that will enable the college community to focus on providing the highest quality and level of education and learning.

We ask that anyone who is interested in receiving District messages disseminated by Campus Police concerning health and safety conditions, both emergency and non-emergency, to download the Campus Shield app onto their smartphones. Additionally, through the app, users are able to receive immediate service(s) through the emergency system or make reports to Campus Police. To further assist the campus community, Campus Police encourages all to download crimemapping.com by going to the City of Merced Police Department Website. The app will provide you with crime related incidents that occur on and around the campus.

Campus Police is dedicated to providing the highest level of professional police service to the Merced College Community with pride, honor, and integrity.

Chief Jeff Horn
Merced Community College District
Campus Police

MERCED COMMUNITY COLLEGE DISTRICT CAMPUS POLICE

MISSION STATEMENT

Our mission is to provide responsive, professional and caring law enforcement services to all the people of the Merced Community College District. We will respond to calls for service promptly, protect lives and property to the very best of our abilities, initiate and maintain crime prevention programs, and apprehend criminal offenders.

As Merced Community College District Police Department employees, we will always conform to the high standards expected by the public, by being fair, compassionate, unbiased and in conformance with the "Law Enforcement Code of Ethics."

DEPARTMENT INFORMATION

Merced College Campus Police is comprised of 1 Director of Law Enforcement, 5 full time sworn Peace Officers, 4 full time non-sworn citation officers, 1 administrative assistant and 5 extra help citation officers. Campus Police patrol both the Merced and Los Banos campuses; as well as, the Business Resource Center (BRC) providing primary law enforcement service and community policing.

As a POST certified police department, Merced Community College District Police respond to a variety of calls for service which include calls for crimes in progress, medical calls for sick or injured persons and vehicle collisions. Police personnel enforce federal, state and local laws, including criminal law(s), vehicle code violation(s), investigate criminal traffic cases that occur within the District. Merced Community College Campus Police operate as a separate jurisdiction working in conjunction with the Merced City Police Department.

The existence of the Merced Community College District Police Department is based upon the following factors:

- The need to provide a level of law enforcement which ensures the safety of students and staff on campus.
- The need to provide those services in a community oriented policing manner which is complementary to the college mission.
- The need to provide service for community activities held on the Merced Community College District campuses.

Campus Law Enforcement Authority

The Merced Community College District Campus Police is a California Peace Officers Standards and Training accredited police department established by the Board of Trustees Policy 7600. The College District is committed to full implementation of the Student Right to Know and Campus Safety Act of 1990 and the Jeanne Clery Disclosure of Campus Security and Campus Crime Statistics Act. The Merced College Police Department consists of a Director of Law Enforcement, police officers, citation officers, and an administrative assistant/dispatcher.

The responsibilities of Campus Police include campus security, traffic, parking control, prevention and detection of crime, and enforcement of federal, state, and municipal laws. Campus Police has the primary responsibility for directing, planning, and controlling vehicle and pedestrian traffic on college grounds. Campus police assists in maintaining of the painting of roadways and curbs, placement of control signs, removal of hazardous obstructions, and other related tasks.

Campus Police personnel make inspections of facilities to insure physical security; design and present programs to reduce risk from criminal acts; review plans and new construction additions to facilities to insure against design defects that could contribute to criminal acts; make preventative patrols of grounds; make necessary arrests and detentions; and interact with all other law enforcement and investigative agencies.

Police Officers receive continuing professional training in first aid, CPR, emergency response, disaster preparedness, defensive tactics, and other topics each year. All police officers have graduated from a regional police academy and have full police powers per 830.32(a) of the Penal Code and 72330 of the Education Code.

Citation Officers are not police officers but are provided special authority by the California Penal Code, California Vehicle Code and Education Code to enforce campus rules and regulations. Citation Officers are the first line of support for the campus police officers. Many are trained in and have the responsibility for collecting field evidence, taking crime reports, and parking enforcement. Citation Officers are also trained in first aid, CPR, and emergency response procedures. Citation Officers also provide general community oriented services.

Administrative Assistant/Dispatcher provide information to the public, dispatch officers to calls for service or crimes in progress, answer the Campus Police office telephone calls, maintain accurate and detailed records, log calls for service, compile information and data for statistical and financial reports, and provide support services for field officers.

Campus Police Contacts

Campus Police Mailing Address

3600 M Street, MS-39
Merced, CA 95340

Campus Police Main Office

3600 M Street,
Public Safety Complex, Building 4
Merced, CA 95340

Main Office Phone	(209) 386-6600
Direct Connect from a District Phone	Extension 6600
Automated Informational Line	(209) 384-6054
Main Office Fax	(209) 381-6454
Emergency	9-1-1 (on district phone, 8-911)

Merced Campus After Hours

Merced City Police Department	(209) 385-6905
Emergency	9-1-1 (on district phone, 8-911)

Our office hours are Monday through Friday from 8:00 a.m. to 4:30 p.m. and closed between the hours of 12:00 p.m. and 1:00 p.m.

Campus Police personnel are available Monday through Friday from 7:00 a.m. to 11:00 p.m. and select hours on Saturday and Sunday.

Campus Police - Los Banos Campus Office

22240 Highway 152
Los Banos, CA 93635

Office Phone	(209) 381-6425
Direct Connect from a District Phone	Extension 6425
Automated Informational Line	(209) 384-6054
Office Fax	(209) 381-6454
Emergency	9-1-1 (on district phone, 8-911)

Los Banos Campus After Hours

Los Banos Police Department	(209) 827-7070
Merced Sheriff's Department	(209) 385-7445
Emergency	9-1-1 (on district phone, 8-911)

Campus Police personnel are available Monday through Friday from 7:00 a.m. to 10:00 p.m.

Uniform Campus Crime Report

The Merced Community College District Campus Police is required to provide the United States Department of Justice with an annual report containing the number and type of criminal offenses committed within the jurisdiction of the Merced College Campus Police, as well as, citations issued and arrests made. This information is forwarded to the Federal Bureau of Investigation for inclusion in the F.B.I. annual publication, Crime in the United States.

In 1990, the U.S. Congress enacted the “Crime Awareness and Campus Security Act of 1990,” requiring colleges and universities to disclose information about crime on and around their campuses. This law was renamed in 1992 to the, “Jeanne Clery Disclosure of Campus Security Policy and Campus Crime Statistics Act.” The federal Clery Act requires the college district to provide additional information to the U.S. Department of Education and to the neighboring communities. Crimes that must be reported include the following:

- **Murder/Non-negligent manslaughter**
- **Manslaughter by Negligence**
- **Rape**
- **Fondling**
- **Incest**
- **Statutory rape**
- **Robbery**
- **Aggravated assault**
- **Burglary**
- **Motor vehicle theft**
- **Arson**

In addition, the college district must report Hate Crimes, Violence Against Women Act (VAWA) offenses and arrests or disciplinary action referrals for liquor, drugs, and weapons offenses. VAWA offenses include:

- **Domestic Violence**
- **Dating Violence**
- **Stalking**

The Clery Act requires that any college official (Campus Safety Authority) having knowledge of any criminal acts occurring on any campus as defined in the Clery Act must report that information to Campus Police for inclusion in the annual security report.

Students Right to Know

The Merced Community College District Campus Police's Annual Security Report publication is the Department's "Student Right to Know" report.

Students and employees are informed that a digital or hard copy of the Campus Annual Security Report publication is available to them. Information of the availability of this publication is also provided on the Merced College website, Merced College catalog, and semester schedule of classes.

A Daily Crime and Activity log is maintained at the front desk in the Campus Police office within the Merced campus and is available for view by the general public between 8:00 am and 5:00 pm, Monday through Friday.

Jeanne Clery Act information is available at:

<https://www.clerycenter.org/the-clery-act>

Crime Reporting Procedures

The Merced Community College District endorses a crime reporting policy that encourages students, faculty, staff, guests, visitors, and the general community to report all criminal activity, emergencies, or unsafe conditions to Campus Police in a timely manner. Campus Police officers will be dispatched to all calls for service including crimes and/or emergencies. Appropriate fire, medical, or emergency response personnel will also be notified and requested to respond as necessary.

Report a crime by calling: Merced Campus (209) 386-6600
 Los Banos Campus (209) 381-6425

Call Procedures for Emergencies

Main Office Phone	(209) 386-6600
Direct Connect from a District Phone	Extension 6600
Main Office Fax	(209) 381-6454
Emergency	911 (on District phone dial 8-911)

After Hours

Afterhours call to Merced campus' Campus Police will automatically forward to the Merced City Police Department. You may also contact Merced City Police direct at:
(209) 385-6905 or by dialing 9-1-1 in an emergency

Afterhours call to the Los Banos' Campus Police will automatically forward to the Los Banos City Police Department. Their dispatch number is: **(209) 827-7070**.
In addition, you may contact Merced County Sheriff's Office, as well, at **(209) 385-7445**.
Emergency services can be reached by dialing 9-1-1

Emergency Code Blue Box

There are Emergency Code Blue yellow phone boxes located throughout campus connecting directly to Campus Police. These can be found in the following locations of the Merced Campus:

- Agriculture building, north side
- Art building, north-east side
- Communication building, east side
- Parking Lot P8, south of parking lot on sidewalk
- IAC building, on west side of building C
- Vocational building, middle of first floor

The Los Banos Campus has emergency phones located in each parking lot connecting to Campus Police during normal hours and the Los Banos City Police Department after hours.

In addition, emergency phones can be located inside all elevators and will be connected directly to Campus Police once the receiver is picked up.

Parking Information

Under state law (Education Code 72247) all parking on a community college campus is subject to payment of a specified fee. It is a privilege extended by the Board of Trustees to the faculty, staff, students, and visitors.

Traffic regulations governing the conduct of operation of motor vehicles on the campus of Merced College and the Los Banos Campus are established in accordance with various provisions of the California Vehicle Code as well as policies established by the Board of Trustees of the District. In the absence of any special regulations not provided for herein, the provisions of the California Vehicle Code relating to vehicular traffic shall apply.

Traffic Control Devices: The driver of any motor vehicle shall obey the instructions of any official traffic control device unless otherwise directed by competent authority (Law Enforcement Personnel).

No person shall operate any motor vehicle while it is in an unsafe condition on Merced Community College District campuses.

Parking on both Merced and Los Banos Campus:

Parking for students is authorized with a daily parking permit or a semester parking permit except in stalls marked as STAFF parking. As it states on the Merced College Campus Police website and in both the Merced College Catalog and Semester Class Schedule, parking on campus is by permit only. This includes all streets and parking lots on campus. Parking permits must be properly displayed at all times. Day permits cost \$2 and may be purchased from the permit dispensers located in various parking lots throughout campus. Disabled parking placards or license plates shall be displayed in conjunction with a valid parking permit.

Student semester parking permits may be purchased online at www.mycampuspermit.com for \$30.

Motorcycles, if parked in a parking stall, require a parking permit and are subject to the same regulations as vehicles. Motorcycle parking permits can be purchased online, as well. No motorcycle parking permit will be mailed, instead license plate and motorcycle information will be stored. This also pertains to open top vehicles. Parking permit is not required for motorcycles if parked in designated motorcycle only stalls.

Bicycles are only to be secured in designated bike racks and NOT to hand rails, trees or lamp posts outside of classrooms/buildings. Violations are subject to citation.

Overnight parking on District grounds require prior authorization from the Office of the Vice President of Administrative Services. Vehicles in violation are subject to fine or tow. Contact Campus Police or V.P. of Administrative Services for further information.

Basic Speed Laws

The following speed limits shall be observed:

1. All roadways on Campus - 25 mph (unless lower speed posted)
2. University Avenue - 15 mph
3. Parking Areas - 15 mph

Traffic Accidents/Collisions

Reporting of on-campus accidents is required under Sections 20002, 20005, 20007, and 20008 of the California Vehicle Code. If you are involved in a traffic accident or witness a traffic accident, contact Campus Police **(209) 386-6600**. Violators are subject to prosecution under the California Vehicle Code or disciplinary action per Merced Community College policy.

Disabled Persons

Disabled persons displaying either State of California license plates or placards issued for disabled parking purposes or disabled parking permits obtained from Merced College's Disabled Students Programs and Services (DSP&S) may park in spaces reserved for the disabled. These spaces are marked with the standard blue painted Disabled Insignia.

For further information on Disabled Parking Permits contact DSP&S.

Disabled parking lots are enforced 7 days a week and 24 hours a day – No Exception. Valid semester parking permit or daily parking permit must be displayed, as well. Violations are subject to citation.

Parking Permits

Both students and community members may purchase semester parking permit online at www.mycampuspermit.com. Current students will need to log in with their college username and password. Community members who wish to purchase a parking permit must create an account. At completion of purchase, a temporary pass will be emailed to you. This temporary pass must be displayed in vehicle until the actual parking permit is received through USPS mail. Temporary parking permit is valid for 14 days and is non-transferrable. Please see Student Help Desk if you are a current student and is unable to log in. Contact Campus Police if parking permit is not received within 14 days.

Parking Permits Required

Parking Permits **MUST** be visibly displayed. Daily Permits should be displayed on the vehicle's dashboard. Semester parking permits should be hung from the rearview mirror, facing forward, or placed on the vehicle's dashboard in an unobstructed view.

Security Awareness and Crime Prevention

Crime prevention material is distributed by Campus Police Services to the campus community. Campus Police makes inspections of facilities to ensure physical security, design and present programs to reduce risk from criminal acts, review plans and new construction additions to facilities to insure against design defects that could contribute to criminal acts, make preventative patrols of grounds, make necessary arrests and detentions, and interact with other law enforcement and investigative agencies to accomplish this task.

Crime prevention and safety brochures such as Preventing Sexual Assault, Escort Service, Earthquake Procedures, First Aid Instructions, and safety tips are provided by Campus Police. Material includes how to call Campus Police for emergencies and how to report crimes. These brochures are available to students during registration for fall and spring semester classes and summer classes. They are available at various locations on the Merced College campuses and available on-line.

The Merced Community College District and Campus Police are committed to providing a safe and secure learning and working environment. The safety of each student and employee are of paramount concern. Information regarding the following topics is provided to assist students and employees in learning about these topics, learning about how to avoid and prevent these types of offenses, and what to do in the event you or someone you know becomes a victim or has questions or concerns.

Campus Police Safety Tips <https://www.mccd.edu/campus-life/campus-safety/campus-police/safety-tips/>

Merced College Student Health Services <https://www.mccd.edu/student-support/student-health-services/health-resources/>

Merced College Personal Counseling <https://www.mccd.edu/student-support/student-health-services/personal-counseling/>

Identity theft – General Guide <https://www.consumer.ftc.gov/articles/0235-identity-theft-protection-services>

Domestic Violence <https://victimconnect.org/learn/types-of-crime/domestic-violence/>

Stalking <https://victimconnect.org/learn/types-of-crime/stalking/>

Sexual Assault/Rape <https://victimconnect.org/learn/types-of-crime/sexual-assault/>

Valley Crisis Center <http://www.valleycrisiscenter.org/>

The Campus Police Department's primary responsibility is the safety and security of all members of the college community. Every effort is made to timely warn and inform students and staff of criminal activity or any other concern that may be of an immediate threat to the safety and security of those on campus. Information and workshops on crime prevention are made available to students and staff throughout the academic year. It is the responsibility of every member of the campus community to act in ways that promote the safety of self, other, and the protection of college district property.

Timely Warning Policy

The Merced Community College District and Campus Police believe that a well-informed community is an integral component in ensuring and maintaining safe and secure campuses and learning environment. Crime information is provided to the college community by the Annual Security Report and the Merced Community College website.

On occasion, a timely warning notice describing recent crime trends or dangerous incidents are issued by Campus Police to the college community. It is our policy to make notifications via:

Campus Shield

E-mail

Mass Notification

Posting printed notices on building entrances and bulletin boards

Posting notices on the Merced college website, www.mccd.edu

Warning Notice Bulletins will include information about the incident and crime prevention recommendations.

Campus Shield – Is an emergency messaging service or SMS (text) technology designed for college and university communities and enterprises. Campus authorities send text messages to subscribers' mobile devices communicating critical campus information and updates to students, staff, and faculty in real time. It also has features to allow community members to act by sending text, photos and videos directly to law enforcement. Friends and family members are also able to subscribe to receive text messages and updates.

Subscribe by downloading the **Campus Shield** app from Google Play or the Apple App store. For more information, contact Campus Police.

<https://www.mccd.edu/campus-life/campus-safety/emergency-preparedness/>

Access & Security to Campus Facilities

The campus facilities are maintained by the Facilities Department and patrolled by Campus Police. Campus Police officers regularly test the emergency phones and submit work orders for repair, recommend maintenance of shrubbery for safety reasons and conduct periodic lighting surveys. Officers report the need for replacement of lights and any other physical hazards noticed. Lighting improvements are constantly being evaluated. Improvements have included the placement of additional lights in buildings, parking lot areas, in areas with heavy landscaping and trees, and along pathways frequently traveled by students. Outdoor emergency phones are located on the campuses. All emergency telephones are connected directly to Campus Police Services.

Safety of Campus Facilities:

The Merced Community College District does not provide housing or residences for students, faculty, or staff on or off-campus. Regarding on-campus security, Merced Community College strives to:

- Create and maintain an environment for learning that promotes respect and appreciation of scholarship, freedom, human diversity and the cultural mosaic of the campus community.
- Promote excellence in instruction and intellectual accomplishments.
- Provide broadly accessible higher education for all people.

Campus Police participates in delivery of the College's mission and strives to create a safe environment conducive to academic excellence. Crime is a nationwide problem and Campus Police strives to make the campus community a safe and secure environment.

Facilities Department: (209) 384-6225

Escort Service

Merced Community College District members may request an officer to escort them to their vehicle or classroom, if they should, for any reason, feel uneasy about walking by him/herself. Be aware that it can take some time before an Officer can respond due to other service calls. If the Officer is not readily available, he/she will inform the requestor of the approximate length of time before they become available to escort due to other service calls.

To request an escort in person, please stop by the Campus Police Department, located in Public Safety Center building 4, between 8:00 a.m. and 4:30 p.m., Monday through Friday.

To call in a request for an escort on the Merced Campus, please dial:

6600 from District phones or **(209) 386-6600**, from non-campus phones.

For Los Banos Campus, please dial:

6425 from District phones or **(209) 381-6425** from non-campus phones.

Alcohol and Drug Abuse and Weapons Policies

Merced Community College District complies with the Drug Free Workplace Act of 1990 and the Higher Education Act Section 120a. The Merced Community College District is committed to an alcohol and drug free environment for all students, faculty, and staff.

In accordance with Public Law 101-226 "Drug Free Schools and Communities Act Amendment of 1989," the Board of Trustees of Merced Community College District has enacted the following:

The District shall be free from all drugs and from the unlawful possession, use or distribution of illicit drugs and alcohol by students and employees.

The unlawful manufacture, distribution, dispensing, possession or use of a controlled substance is prohibited in all facilities under the control and use of the District.

Any student or employee who violates this policy will be subject to disciplinary action (consistent with local, state or federal law), which may include referral to an appropriate rehabilitation program, suspension, demotion, expulsion or dismissal.

The President/Superintendent shall assure that the District distributes annually to each student the information required by the Drug-Free Schools and Communities Act Amendments of 1989 and complies with other requirements of the Act.

Campus Police strictly enforces Federal, State, and local laws, as well as the college's zero-tolerance policy, for the use, possession, or sale of illegal drugs.

Any student who feels that he/she has a drug or alcohol problem is urged to voluntarily seek assistance through the Merced Community College Student Health Center.

Employees are referred to the Merced Community College Human Resources Office for referral to employee assistance programs.

Firearms and other dangerous weapons of any kind are not permitted on campus except as permitted by state and federal law. The use, possession, sale, or transfer of firearms or any other weapon is strictly prohibited on any campus by state law, the student code of conduct, and college district policy.

Note: Criminal prosecution is separate from any administrative discipline that may be imposed by the Merced Community College District.

Alcohol Rehab Guide <https://www.alcoholrehabguide.org/>

Alcoholics Anonymous <http://www.aa.org>

Sexual Assaults and Sexual Offender Registration Laws

Sexual Assault Policy

Merced College has a zero tolerance policy for sexual assault. The Merced Community College District recognizes that sexual assault is a serious issue and will not tolerate any sexual assault actions on campus. Campus Police will investigate all allegations of sexual assault and take appropriate police action. The Merced Community College District will also take appropriate disciplinary or legal action. In addition to criminal prosecution, school disciplinary sanctions range from reprimand to suspension to expulsion from the College. During a disciplinary hearing, the accuser and the accused are entitled to due process, including the right to have others present at the hearings and a right to the same information regarding the outcome of the disciplinary hearings.

If a Sexual Assault Occurs

As soon as possible, the victim of a sexual assault should report the incident to Campus Police, the local police department or any faculty or staff member. The victim should make every attempt to preserve any physical evidence of the assault. This may include a voluntary medical exam, not showering, and not disposing of any damaged clothing or other items that are present during/after the assault. Victims are encouraged to call any law enforcement agency by dialing 911 after a sexual assault for a crime investigation, referral or transport for medical treatment, and referral to crisis counseling and legal advocacy.

Disciplinary actions may be imposed on individual students, student organizations and/or any College faculty or staff responsible for a sexual assault. College sanctions following campus disciplinary procedures depend on the outcome and may range from reprimand to expulsion. Every effort will be made to criminally prosecute perpetrators of sexual assaults. The accuser and the accused are entitled to the same opportunities to have others present during a campus disciplinary proceeding and both shall be informed of the outcome.

The College's Sexual and other Assault on Campus Policy is explained in the Merced Community College District Administrative Procedures (AP3540), which is available at <https://www.mccd.edu/about-merced-college/leadership/board-of-trustees/policies-procedures/>

Sexual Assault Prevention Programs

The Merced Community College District's sexual assault program entails presentations, providing information to students and employees on how to prevent and avoid sexual assaults, and what to do if you are the victim of a sexual assault. There are also courses in understanding violent offenders in the Merced Community College Administration of Justice program. This course is a study of the violent crimes, the various types of homicide, and the characteristics of both the offender and the victim. Students should check the Schedule of Classes each semester to determine when these classes are offered.

Information regarding what to do if you are the victim of a sexual assault or rape and resources that are available to victims of sexual assault or rape can be located at: <https://victimconnect.org/>

If You Are A Victim Of Sexual Assault:

- GET to a safe place
- CONTACT the Campus Police Department at **(209) 386-6600** or call local authorities by dialing **9-1-1** (8-911 from campus phone line)
- DO NOT shower, bathe, douche, change or destroy clothing
- DO NOT straighten up or clean the area where the assault took place
- SEEK medical attention
- SEEK the counseling and legal assistance from a rape treatment center.

Local Resources: Valley Crisis Center: **(209) 722-HELP (4357)**

Merced College Student Health Services: **(209) 384-6045**

Notice: The Merced Community College District will change a victim's academic situation after an alleged sex offense and inform the victim of the options for those changes, if those changes are requested by the victim and are reasonably available. Victims of sexual assault may report the crime to any Merced College faculty, staff, or administrator, but the Campus Police Services office should be notified as soon as possible. Victims or witnesses to crimes should follow the basic policy for reporting crimes. This policy can also be found in the [College Catalog](#).

Preventing Sexual Assaults

Knowing the facts about rape...

Rape is a violent crime - a hostile attack - an attempt to hurt and humiliate. It is NOT the result of "uncontrolled passions." Rape can happen to anyone. Children, grandmothers, students, working women, wives, mothers, and even males are the victims of rape. Rape can occur anywhere and at any time in public or in your own home, day or night. Rapists are not necessarily strangers. In fact, in over one third of reported cases, the rapist is an acquaintance, neighbor, friend, or relative of the victim.

Prevention Tips...

First, know the facts about rape. Become aware of locations and situations where rape could occur, and avoid them. Consider your alternatives if confronted by a rapist. Practice possible responses so that you can recall them even under the stress of a real encounter.

Outdoors...

- Be alert to your surroundings and the people around you - especially if you are alone or it is dark.
- When possible, travel with a friend.
- Stay in well-lit areas as much as possible.
- Walk confidently, directly, at a steady pace. A rapist looks for someone who appears vulnerable.
- Walk on the side of the street facing traffic.
- Walk close to the curb. Avoid doorways, bushes, and alleys where rapist can hide.
- If you think you are being followed, walk quickly to areas where there are lights and people.
- If a car appears to be following you, turn and walk in the opposite direction, or walk on the other side of the street.
- If in danger - scream and run, or yell fire, or break a window to attract attention.

At home...

Many rapes occur in or near the victim's home. One of the best ways to prevent sexual assault is to practice good home security.

- Install effective locks on all doors and windows - and use them.
- Install a peephole viewer in your door. NEVER open your door without knowing who is on the other side. Require salespersons or repairmen to show identification.
- If strangers telephone or come to your door, don't admit that you are alone.
- If you live in an apartment, avoid being in the laundry room or garage by yourself, especially at night.
- If you come home and find a door or window open or signs of forced entry, don't go in. Go to the nearest phone and call the police.

Car safety...

- Always lock car doors after entering or leaving your car.
- Park in well-lit areas.
- Have your car keys in your hand so that you don't have to linger before entering your car. Keys can also serve as a possible weapon against an attacker.
- Check the back seat before entering your car.
- If you think you are being followed, drive to a public place or a police station.
- If your car breaks down, open the hood and attach a white cloth to the car antenna.
- If someone stops to help, stay in your locked car and ask them to call the police or a garage.

If attacked...

Remember your main concern must always be your safety. No one can tell you whether you should fight back, submit, or resist. **IT DEPENDS ON YOU AND THE SITUATION.** However, your best defense is to be prepared - know your options ahead of time. Your safety may depend upon your ability to stay cool and calm.

Weapons...

Carrying weapons for self-defense is controversial and sometimes illegal.

Be safe – for more information, contact your local law enforcement agency.

If you are a victim of a rape....

Get help quickly. Call the police, sheriff, a rape crisis center, doctor, friend, or relative.

- Do NOT wash, douche, change clothes or clean up in any way until after talking to the police and going to the hospital. (You could destroy valuable evidence.)
- Remember you are the victim. You have nothing to feel guilty or ashamed about.

To learn more about sexual assault and how to prevent, contact your local law enforcement agency, rape crisis center, or write to:

Crime Prevention Center
Office of the Attorney General
1515 K Street
Sacramento, CA 95814

Or go to:

Valley Crisis Center
<https://www.valleycrisiscenter.org/>

“loveisrespect”
<http://www.loveisrespect.org/>

Megan's Law: Registered Sex Offender Information

It is the policy of Campus Police to provide information regarding threats to the safety of the campus community arising from Serious and High Risk Sex Offenders on or near the Merced Community College District campus.

Convicted sexual offenders who are required to register by State or Federal law are required to register with the Campus Police Department if attending the college as a student or employed by the college district in any capacity, including volunteer or unpaid aide, and any person working or carrying on a vocation at the college (e.g. contractors) for more than 14 days or for an aggregate period exceeding 30 days in a calendar year (paid workers or volunteers).

Information regarding any person who has been convicted of a sexual offense and required to register pursuant to Section 290 of the California Penal Code can be viewed by any student, employee, or member of the general public at the Campus Police Office on the Merced campus, Monday through Friday during normal business hours.

The release of this information will be made for the purpose of allowing members of the campus community to protect themselves and their children from Serious and High Risk Sex Offenders.

Any of the information released regarding Serious and High Risk Sex Offenders will be done strictly in compliance with the provisions of sections 290 and 290.4 of the California Penal Code.

Campus Police may make notification to any of the following persons, agencies, or organizations the offender is likely to encounter including, but not limited to:

1. Public and private educational institutions.
2. Day care establishments.
3. Locations that primarily serve individuals likely to be victimized by an offender.
4. Other community members at risk.

Pursuant to provisions of section 290 (m) of the California Penal Code, Campus Police may provide the following information regarding a Serious and High Risk Sex Offenders to any of the persons, agencies, or organizations authorized to receive information:

1. The offender's full name.
2. The offender's known aliases.
3. The offender's gender.
4. The offender's race.
5. The offender's physical description.
6. The offender's photograph.
7. The offender's date of birth.
8. Crimes resulting in registration under 290 PC.
9. The offender's address, which must be verified prior to publication.
10. Description and license plate number of offender's vehicles or vehicles the offender is known to drive.
11. Type of victim targeted by the offender.
12. Relevant parole and probation conditions, such as one prohibiting contact with children.
13. Dates of crimes resulting in classification under this section.
14. Date of release from confinement.

Information disclosed pursuant to this procedure must not include information that would tend to identify the victim.

PUBLIC ACCESS TO "MEGAN'S LAW" DATA: Section 290.4 of the California Penal Code mandates that the Department of Justice, Sheriff's Departments, and the municipal police departments of cities with population of more than 200,000 make the "Megan's Law" data available to the public for viewing.

For further information on how to obtain access to "Megan's Law," contact Merced Police Department at (209) 385-6913 or Los Banos Police Department at (209) 827-7070.

Victims' Bill of Rights Act of 2008: "Marsy's Law"

On 11/4/08, by enacting Proposition 9, referred to as the "Victims' Bill of Rights Act of 2008: Marsy's Law" the California citizens voted to provide victims of crimes with certain constitutional rights. By enacting Proposition 9, the California Constitution, Article I, Section 28 (b), has been amended and hereby confers the following rights to those who are victims of crime as defined in the constitution:

In order to preserve and protect a victim's rights to justice and due process, a victim shall be entitled to the following rights:

- To be treated with fairness and respect for his or her privacy and dignity, and to be free from intimidation, harassment, and abuse, throughout the criminal or juvenile justice process.
- To be reasonably protected from the defendant and persons acting on behalf of the defendant.
- To have the safety of the victim and the victim's family considered in fixing the amount of bail and release conditions for the defendant.
- To prevent the disclosure of confidential information or records to the defendant, the defendant's attorney, or any other person acting on behalf of the defendant, which could be used to locate or harass the victim or the victim's family or which disclose confidential communications made in the course of medical or counseling treatment, or which are otherwise privileged or confidential by law.
- To refuse an interview, deposition, or discovery request by the defendant, the defendant's attorney, or any other person acting on behalf of the defendant, and to set reasonable conditions on the conduct of any such interview to which the victim consents.
- To reasonable notice of and to reasonably confer with the prosecuting agency, upon request, regarding, the arrest of the defendant if known by the prosecutor, the charges filed, the determination whether to extradite the defendant, and, upon request, to be notified of and informed before any pretrial disposition of the case.
- To reasonable notice of all public proceedings, including delinquency proceedings, upon request, at which the defendant and the prosecutor are entitled to be present and of all parole or other post-conviction release proceedings, and to be present at all such proceedings.
- To be heard, upon request, at any proceeding, including any delinquency proceeding, involving a post-arrest release decision, plea, sentencing, post-conviction release decision, or any proceeding in which a right of the victim is at issue.

- To a speedy trial and a prompt and final conclusion of the case and any related post-judgment proceedings.
- To provide information to a probation department official conducting a pre-sentence investigation concerning the impact of the offense on the victim and the victim's family and any sentencing recommendations before the sentencing of the defendant.
- To receive, upon request, the pre-sentence report when available to the defendant, except for those portions made confidential by law.
- To be informed, upon request, of the conviction, sentence, place and time of incarceration, or other disposition of the defendant, the scheduled release date of the defendant, and the release of or the escape by the defendant from custody.
- To restitution.
 - It is the unequivocal intention of the People of the State of California that all persons who suffer losses as a result of criminal activity shall have the right to seek and secure restitution from the persons convicted of the crimes causing the losses they suffer.
 - Restitution shall be ordered from the convicted wrongdoer in every case, regardless of the sentence or disposition imposed, in which a crime victim suffers a loss.
 - All monetary payments, monies, and property collected from any person who has been ordered to make restitution shall be first applied to pay the amounts ordered as restitution to the victim.
- To the prompt return of property when no longer needed as evidence.
- To be informed of all parole procedures, to participate in the parole process, to provide information to the parole authority to be considered before the parole of the offender, and to be notified, upon request, of the parole or other release of the offender.
- To have the safety of the victim, the victim's family, and the general public considered before any parole or other post-judgment release decision is made.
- To be informed of the rights enumerated in paragraphs (1) through (16)
- The above Marsy Rights are to be provided to each crime victim pursuant to Penal Code Section 679.026

For more information visit the [State of California Department of Justice](#).

Merced College Policy Regarding Workplace Violence

The Merced Community College District has a zero tolerance policy regarding threatening, intimidating, or harassing behavior in the workplace. If you feel concerned for your safety because of the behaviors of another employee or any member of the campus community, you should advise your Dean, Supervisor, Manager and/or Campus Police as appropriate. In case of an emergency call **911**.

If you are the victim of any type of violence in the work place, are verbally or otherwise threatened with violence, or witness any acts of violence or threats of violence in the workplace, notify Campus Police at **(209) 386-6600** immediately.

Each threat or act of violence will be immediately and thoroughly investigated by the appropriate law enforcement agency and by the appropriate administrator in consultation with the Vice President of Administrative Services and the President.

Employees who act in violation of this policy and/or the law will be subject to arrest and/or disciplinary action, up to and including dismissal. Such disciplinary action shall be in accordance with District policies, state and federal laws, and/or the collective bargaining agreements.

Hate Crimes

Hate crimes defined by the California Penal Code are any acts of physical intimidation or physical harassment, physical force or physical violence, or the threat of physical force or violence, that is directed against any person or group of persons because of the ethnicity, race, national origin, religion, sex, sexual orientation, disability, political or religious beliefs of that person or group.

The Merced Community College District does not condone hate violence and is charged with ensuring that the rights guaranteed by state and federal law and the U.S. Constitution are protected for all people, regardless of their ethnicity, race, national origin, religion, sex, sexual orientation, disability, or political or religious beliefs.

Incidents of hate violence can be reported to:

Campus Police at **(209) 386-6600**

Student Health Center at **(209) 384-6045**

Vice President of Student Services at **(209) 384-6185**

Human Resources Department at **(209) 384-6295**

Emergency Response and Evacuation Policy

The Merced Community College District Campus Police officers have been trained in Incident Command and response to critical incidents on campus. In the event of an immediate threat to the health or safety of the college community first responders to the scene can be the, Merced, Merced County Sheriff's Department, or Los Banos Police Department, Merced or Los Banos Fire Department, and Merced College Student Health Services. These first responders work together to manage the incident and depending on the nature of the incident could call-in other city, county, state or federal agencies to assist.

Campus Police receives emergency and incident information from various sources such as: dispatchers, Merced County Sheriff's Department, Merced Police Department, Los Banos Police Department, and other law enforcement agencies. If Campus Police confirms there is an emergency or incident that poses an immediate threat to the college community, Campus Police can act unilaterally or in collaboration with other agencies to notify the college community. The content of the emergency notification will be determined by the type and size of the incident. Campus Police or other first responders may send immediate notifications by email, text messaging, phone call, or loud speaker. Immediate notifications may be sent by one or all of these methods depending on the type of incident.

Evacuation drills are performed at both Merced Community College District Campuses at least once a year. The evacuation drills are conducted by Campus Police services, the Safety Committee, and the Emergency Preparedness Coordinator. The purpose of evacuation drills is to conduct an assessment of the District's response to emergency protocols, which includes the ability to evacuate buildings safely and in a timely manner, ensure the safety of all employees, students and guests, and assess training and resource needs.

American Red Cross <http://www.redcross.org/>

California Department of Public Health <http://www.bepreparedcalifornia.ca.gov>

Emergency Procedures: Fire

IF YOU SMELL SMOKE OR SEE FIRE

- When a fire alarm sounds, you must leave the building immediately. Failure to do so may result in personal injury or disciplinary action.
- When out of danger, activate the nearest alarm and or dial 9-1-1
- If you are instructed to evacuate, leave the area as quickly and safely as possible.
- Use the stairs to evacuate, never use the elevator in the event of a fire.
- Before opening a door, use the back of your hand to see if it is hot. If the door is hot, do not open it. Stuff clothing beneath the door to prevent smoke from coming in.
- Open a window.
- If the door is not hot, open it slowly and look into the hallway for signs of smoke or fire before leaving the safety of the office or room.
- Remember to stay low if there is smoke in the air.
- Assist all persons with disabilities.

Emergency Procedures: Earthquake

During an earthquake, remain calm and quickly follow the steps outlined below.

- If indoors, seek refuge in a corner, under a desk or table. Avoid windows, shelves, and heavy equipment. **Drop and Cover.**
- When the earth is shaking, **DROP** to your knees, clasp both hands behind the neck, bury your face in your arms, make your body as small as possible, close eyes and cover ears with forearms.
- If outdoors, move quickly away from buildings, utility poles, and other structures. **Drop and Cover.**
- After initial shock, evaluate the situation and if emergency help is necessary call the Campus Police Office at Ext. 6600. Protect yourself at all times and be prepared for aftershocks.
- Turn off all potentially hazardous equipment such as gas and electric appliances.
- Damaged facilities should be reported to Facilities at Ext. 6225, if Campus Police has not been contacted already.
- If necessary activate the building alarm system.
- Evacuate the building by quickly walking to the nearest exit, alerting people as you go.
- Be aware of structural damage and assist both the disabled and injured.
- **FLASH THE LIGHTS ON AND OFF** to alert deaf or hard of hearing students. Write notes to explain what is happening.
- Once outside, move to a clear area at least 150-300 feet away from the affected building(s). Keep walkways clear for emergency vehicles.
- To the best of your ability, and without reentering the building, assist in determining that everyone has evacuated safely.

DO NOT RETURN TO AN EVACUATED BUILDING UNLESS DIRECTED BY APPROPRIATE AUTHORITY.

Emergency Procedures: Shooting / Sniper / Violent Armed Individual

Types of Shooting Incident/Situation

The type of shooting incident/situation will determine the appropriate response.

- **If you are outdoors**, immediately seek cover and move away from the line of fire.
- **Do not evacuate rooms or the building until instructed to do so** by a Campus Police Officer, the Building Monitor, or a Merced College employee with proper identification or a Merced Police Officer or unless it is absolutely clear that it is safe to do so.
- **EVACUATE ONLY WHEN SAFE AND APPROPRIATE**

[Special precautions must be taken to ensure that persons who have impaired hearing are notified and persons with disabilities are assisted as appropriate.](#)

ONLY WHEN SAFE, Call **911** from a cell phone or **(8-911)** from a college telephone. **Do not hang up** on the dispatcher until instructed to do so. The following information should be provided:

- Indicate that there has been a shooting or that someone has been shot
- The exact location of the suspect(s) including the building number (if applicable), floor number (if applicable), room number (if applicable) or nearest landmarks (bookstore, cafeteria, etc.)
- Whether you actually heard or saw any shots fired, if the suspect(s) is/are still shooting, what type of weapon(s) does the suspect(s) have? Handgun, Rifle, Shotgun or Explosive Device(s)?
- Description of suspect(s): race, clothing, direction of travel, vehicle(s)
- Condition and number of hostage(s) and victim(s) injured or killed
- Any information or demands supplied or made by suspect(s)?

Active Shooter:

- **RUN** – Evacuate the Area
 - Evacuation in most cases is the best answer
 - Don't run in a big group
 - Know the layout of your work site/exits (gates, windows, etc...)
 - Rally points, if you can get there
 - Think outside the box (break a window, jump fence, etc...)
- **HIDE** – If you can't evacuate, lock down in place
 - Lock doors if possible
 - Turn lights off
 - Try to barricade the doors
 - Prepare yourself to fight back if breached
 - Shooter is not going to waste time to un-barricade

- **FIGHT** – Be ready to fight back
 - Be ready to fight back with any means necessary
 - Our job sites are filled with weapons!
 - Use objects to throw at the intruder

Sniper/Barricaded Suspect(s)

- Remain in place of shelter or safety until instructed to evacuate or leave
- Follow instructions of police officer or building monitor
- If shooting is in progress, keep a low profile and silhouette, always maintain cover, be silent, and follow instructions

Violent Armed Individual:

During incidents or situations where a subject is armed with a deadly weapon **other than a fire arm or suspected explosive device**, such as a knife, ax, or club, and is threatening or attacking others, the following actions should be taken:

- The type of incident/situation will determine the appropriate response.
- **If you are outdoors**, immediately move away from the suspect(s) and seek assistance.
- **If you are indoors**, immediately move away from suspect(s) and if possible, block or secure the room door to prevent the suspect(s) from entering.

[Special precautions must be taken to ensure that persons who have impaired hearing are notified and persons with disabilities are assisted as appropriate.](#)

Call 911 on a cell phone or (9-911) from a college telephone. **Do not hang up on the dispatcher until instructed to do so.** The following information should be provided:

- Indicate that there has been an incident involving a weapon and someone has been or may be injured.
- The exact location of the suspect(s) including the building number (if applicable), floor number (if applicable), room number (if applicable), nearest landmarks (bookstore, cafeteria, etc.)
- Whether you actually heard or saw anyone threatening or injuring someone, if the suspect(s) is/are still threatening or injuring anyone, what type of weapon(s) does the suspect(s) have? Knife, Axe, Club or other type of weapon?
- Description of suspect(s): race, clothing, direction of travel, vehicle(s)
- Condition and number of hostage(s) and victim(s) injured or killed
- Any information or demands supplied or made by suspect(s)

First Aid Instructions
Merced College Student Health Office (209) 384-6045

Fainting, Unconsciousness and Shock

Have victim lie or sit down and rest
Keep victim comfortable, not hot or cold
Ask or look for emergency medical I.D. Treat other injuries as necessary

Mouth-to-Mouth Resuscitation

Place victim on side and remove foreign matter from mouth with finger
Place victim on back
Tilt victim's head back to open airway
Close victim's nostrils with fingers
Inhale and place your mouth over victim's mouth
Exhale until victim's chest expands
Repeat every five seconds
Keep trying until help arrives
If problem, check victim for airway obstruction

Severe Bleeding and Wounds

AVOID DIRECT CONTACT WITH BLOOD, IF POSSIBLE WEAR SURGICAL RUBBER GLOVES WHEN BLEEDING IS INVOLVED Apply direct pressure on wound
Use clean cloth or hand
Apply pressure to blood vessel, if necessary
Elevate body part
Add more cloth if blood soaks through
Keep pressure on wound until help arrives Use tourniquet only as last resort

Choking

Check victim's mouth and clear of foreign matter
Lower head and give back blows
Still choking, use abdominal thrusts

Heart Attack

Place victim laying down on back
Give resuscitation or CPR as necessary (if trained) Keep victim comfortable, not hot or cold
Ask or look for emergency medical I.D.

Burns, Thermal and Chemical

Immerse burned area in cold water
Flood chemical burn with cool water
Cover burn with dry bandage
Keep victim quiet and comfortable

Fractures and Sprains

Keep victim still

Keep injured area immobile

CAUTION: HEAD, NECK OR BACK INJURY: Any victim suspected of having head, neck or back injury, keep absolutely still. Treat for shock if necessary and keep warm

Poisoning and Overdose

Determine what substance is involved and how taken

Stay with victim and assist as necessary

If choking, lower head

Annual Disclosure of Crime Statistics

The “**Jeanne Clery Disclosure of Campus Security Policy and Crime Statistics Act**” is a federal law that requires institutions of higher learning (colleges and universities) to disclose campus security information including crime statistics for the campus and surrounding areas. All institutions of post-secondary education, both public and private, that participate in federal student aid programs must publish and disseminate an annual campus security report in addition to providing timely warnings of any criminal activities.

To comply with the Clery Act, the Merced Community College Campus Police Department is responsible for gathering crime statistics and providing safety information to all students, staff, faculty, visitors, and prospective students and employees of the district. Campus Police collects the crime statistics from both campuses and from the local law enforcement agencies located within the cities of Merced and Los Banos.

Geographical Locations

Merced Community College District has two campuses and must comply independently; therefore, this survey will reflect two separate reports:

- Merced Campus, Business Resource Center (BRC) and the surrounding area
- Los Banos Campus, the Welding Shop and surrounding area

On-Campus – Building or property owned or controlled by an institution within the same reasonably contiguous geographic area and used by the institution in direct support of, or in a manner related to, the institution’s educational purposes.

Non-Campus – Any building or property owned or controlled by a student organization that is officially recognized by the institution; or any building or property owned or controlled by an institution that is used in direct support or, or in relation to, the institution’s educational purposes, is frequently used by students, and is not within the same reasonably contiguous geographic area of the institution.

Public Property – All public property, including thoroughfares, streets, sidewalks, and parking facilities, that is within the campus, or immediately adjacent to and accessible from the campus. Public property category consists solely of two limited areas:

- *Within campus*
- *Immediately borders and is accessible from the campus. In many cases this property consists of a public sidewalk that borders the campus, the public street along the sidewalk and the public sidewalk on the other side of the street.*

Reportable Crimes Definition and Information

Merced College utilizes the definitions from the FBI's Uniform Crime Reporting Program's *Summary Reporting System (SRS) User Manual* for murder, rape, robbery, aggravated assault, burglary, motor vehicle theft, arson, weapons: carrying, possessing, etc. law violations, drug abuse violations, and liquor law violations as directed by the Clery Act. Additionally, definitions from the FBI's *National Incident Based Reporting Systems (NIBRS) Data Collection Guidelines* edition of the UCR for fondling, incest and statutory rape. Definitions from the *Violence Against Women Act of 1994* and *Clery Act* regulations were used, as directed, for domestic violence, dating violence and stalking.

Murder/Non-negligent manslaughter – The willful (non-negligent) killing of one human being to another.

Manslaughter by Negligence – The killing of another person through gross negligence.

Rape - The penetration, no matter how slight, of the vagina or anus, with any body part or object, or oral penetration by a sex organ of another person, without the consent of the victim.

Fondling – The touching of the private body parts of another person for the purpose of sexual gratification, without the consent of the victim, including instances where the victim is incapable of giving consent because his/her age or because of his/her temporary or permanent mental incapacity.

Incest – Sexual intercourse between persons who are related to each other within the degrees wherein marriage is prohibited by law.

Statutory rape - Sexual intercourse with a person who is under the statutory age of consent.

Robbery – The taking or attempting to take anything of value from the care, custody, or control of a person or persons by force or threat of force or violence and/or by putting the victim in fear.

Aggravated assault – An unlawful attack by one person upon another for the purpose of inflicting severe or aggravated bodily injury. This type of assault usually is accompanied by the use of a weapon or by means likely to produce death or great bodily harm.

Burglary – The unlawful entry of a structure to commit a felony or a theft.

Motor vehicle theft – The theft or attempted theft of a motor vehicle, not including theft *from* a motor vehicle.

Arson – Any willful or malicious burning or attempt to burn, with or without intent to defraud, a dwelling house, public building, motor vehicle or aircraft, personal property of another, etc.

Hate Crime – A criminal offense that manifests evidence that the victim was intentionally selected because of the perpetrator’s bias against the victim.

Domestic Violence – A felony or misdemeanor crime of violence committed-

- By a current or former spouse or intimate partner of the victim;
- By a person with whom the victim shares a child in common;
- By a person who is cohabitating with, or has cohabitated with, the victim as a spouse or intimate partner;
- By a person similarly situated to a spouse of the victim under the domestic or family violence laws of the jurisdiction in which the crime or violence occurred, or by any other person against an adult or youth victim who is protected from that person’s acts under the domestic or family violence laws of the jurisdiction in which the crime of violence occurred.

Dating Violence – Violence committed by a person who is or has been in a social relationship of a romantic or intimate nature with the victim. The existence of such a relationship shall be determined based on the reporting party’s statement and with consideration of the length of the relationship, the type of relationship, and the frequency of interaction between the persons involved in the relationship. For the purposes of this definition-

- Dating violence includes, but is not limited to, sexual or physical abuse or the threat of such abuse.
- Dating violence does not include acts covered under the definition of domestic violence.

Stalking – Engaging in a course of conduct directed at a specific person that would cause a reasonable person to

- Fear for the person’s safety or the safety of others; or
- Suffer substantial emotional distress.

Weapons: carrying, possessing, etc. – The violation of laws or ordinances prohibiting the manufacture, sale, purchasing, transportation, possession, concealment, or use of firearms, or deadly weapons; cutting instruments, explosives incendiary devices or other deadly weapons, This classification encompasses weapons offenses that are regulatory in nature. Include in this classification: manufacture, sale, or possession of deadly weapons; carrying deadly weapons, concealed or openly; using, manufacturing, etc., of silencers; furnishing deadly weapons to minors; aliens possessing deadly weapons; and attempts to commit any of the above.

Drug abuse violations – The violation of laws prohibiting the production, distribution and/or use of certain controlled substances and the equipment or devices utilized in their preparation and/or use. The unlawful cultivation, manufacture, distribution, sale purchase, use, possession, transportation or importation of any controlled drug or narcotic substance. Arrests for violations, of State and local laws, specifically those relating to the unlawful possession, sale, use, growing, manufacturing, and making of narcotic drugs. The relevant substances include: opium or cocaine and their derivatives (morphine, heroin, codeine); marijuana; synthetic narcotics- manufactured narcotics which can cause true addiction (Demerol, methadone); and dangerous nonnarcotic drugs (barbiturates, Benzedrine).

Liquor Law Violation – The violation of State or local laws or ordinances prohibiting: the manufacture, sale, purchase, transportation, possession or use of alcoholic beverages, not including driving under the influence and drunkenness. Include in this classification: the manufacture, sale, transporting, furnishing, possessing, etc., maintaining unlawful drinking places; bootlegging; operating a still; furnishing liquor to a minor or intemperate person; underage possession; using a vehicle for illegal transportation of liquor; drinking on a train or public conveyance; and attempts to commit any of the above.

CRIME STATISTICS:
Merced Campus
&
Business Resource Center
(BRC)

CRIMINAL OFFENSES

Merced and BRC, 2020/2021/2022

CRIMINAL OFFENSES

OFFENSE TYPE	On Campus			Non-Campus Property			Public Property		
	2020	2021	2022	2020	2021	2022	2020	2021	2022
Murder/Non-Negligent Manslaughter	0	0	0	0	0	0	0	0	0*
Manslaughter by Negligence	0	0	0	0	0	0	0	0	0
Rape	0	0	1	0	0	0	0	0	0
Fondling	0	0	0	0	0	0	0	0	0
Incest	0	0	0	0	0	0	0	0	0
Statutory Rape	0	0	0	0	0	0	0	0	0
Robbery	0	0	0	0	0	0	0	0	0
Aggravated Assault	0	2	0	0	0	0	0	1	1
Burglary	0	1	3	0	0	0	0	0	0
Motor Vehicle Theft <i>*Does not include theft from a motor vehicle</i>	1	0	0	0	0	0	0	0	0
Arson	0	0	0	0	0	0	0	0	0

*As of Nov. 30th, 2023, a revision was made from an entry of one (1) to zero (0). Memorandum was submitted Nov. 30, 2023 explaining the change was due to the one (1) reported incident not having occurred within Clery geography.

<p>CRIMINAL OFFENSES END</p>

HATE CRIMES
ON CAMPUS
Merced and BRC, 2020/2021/2022

HATE CRIMES-ON CAMPUS

2020 TOTAL	2020 Total	Category of Bias for crimes reported in 2020							
CRIMINAL OFFENSE		Race	Religion	Sexual Orientation	Gender	Gender Identity	Disability	Ethnicity	National Origin
Murder/Non-Neg. Manslaughter	0	0	0	0	0	0	0	0	0
Rape	0	0	0	0	0	0	0	0	0
Fondling	0	0	0	0	0	0	0	0	0
Incest	0	0	0	0	0	0	0	0	0
Statutory Rape	0	0	0	0	0	0	0	0	0
Robbery	0	0	0	0	0	0	0	0	0
Aggravated Assault	0	0	0	0	0	0	0	0	0
Burglary	0	0	0	0	0	0	0	0	0
Motor Vehicle Theft <i>*Does not include theft from motor vehicle</i>	0	0	0	0	0	0	0	0	0
Arson	0	0	0	0	0	0	0	0	0
Simple assault	0	0	0	0	0	0	0	0	0
Larceny-Theft	0	0	0	0	0	0	0	0	0
Intimidation	0	0	0	0	0	0	0	0	0
Destruction/Damage/ Vandalism of Property	0	0	0	0	0	0	0	0	0

HATE CRIMES-ON CAMPUS (cont.)

2021 TOTAL	2021 Total	Category of Bias for crimes reported in 2021							
CRIMINAL OFFENSE		Race	Religion	Sexual Orientation	Gender	Gender Identity	Disability	Ethnicity	National Origin
Murder/Non-Neg. Manslaughter	0	0	0	0	0	0	0	0	0
Rape	0	0	0	0	0	0	0	0	0
Fondling	0	0	0	0	0	0	0	0	0
Incest	0	0	0	0	0	0	0	0	0
Statutory Rape	0	0	0	0	0	0	0	0	0
Robbery	0	0	0	0	0	0	0	0	0
Aggravated Assault	0	0	0	0	0	0	0	0	0
Burglary	0	0	0	0	0	0	0	0	0
Motor Vehicle Theft <i>*Does not include theft from motor vehicle</i>	0	0	0	0	0	0	0	0	0
Arson	0	0	0	0	0	0	0	0	0
Simple Assault	0	0	0	0	0	0	0	0	0
Larceny-Theft	0	0	0	0	0	0	0	0	0
Intimidation	0	0	0	0	0	0	0	0	0
Destruction/Damage/ Vandalism of Property	0	0	0	0	0	0	0	0	0

HATE CRIMES-ON CAMPUS (cont.)

2022 TOTAL	2022 Total	Category of Bias for crimes reported in 2022							
CRIMINAL OFFENSE		Race	Religion	Sexual Orientation	Gender	Gender Identity	Disability	Ethnicity	National Origin
Murder/Non-Neg. Manslaughter	0	0	0	0	0	0	0	0	0
Rape	0	0	0	0	0	0	0	0	0
Fondling	0	0	0	0	0	0	0	0	0
Incest	0	0	0	0	0	0	0	0	0
Statutory Rape	0	0	0	0	0	0	0	0	0
Robbery	0	0	0	0	0	0	0	0	0
Aggravated Assault	0	0	0	0	0	0	0	0	0
Burglary	0	0	0	0	0	0	0	0	0
Motor Vehicle Theft <i>*Does not include theft from motor vehicle</i>	0	0	0	0	0	0	0	0	0
Arson	0	0	0	0	0	0	0	0	0
Simple Assault	0	0	0	0	0	0	0	0	0
Larceny-Theft	0	0	0	0	0	0	0	0	0
Intimidation	0	0	0	0	0	0	0	0	0
Destruction/Damage/ Vandalism of Property	0	0	0	0	0	0	0	0	0

HATE CRIMES-ON CAMPUS
END

HATE CRIMES

NON-CAMPUS PROPERTY

Merced and BRC, 2020/2021/2022

HATE CRIMES-NON-CAMPUS

2020 TOTAL	2020 Total	Category of Bias for crimes reported in 2020							
CRIMINAL OFFENSE		Race	Religion	Sexual Orientation	Gender	Gender Identity	Disability	Ethnicity	National Origin
Murder/Non-neg. Manslaughter	0	0	0	0	0	0	0	0	0
Rape	0	0	0	0	0	0	0	0	0
Fondling	0	0	0	0	0	0	0	0	0
Incest	0	0	0	0	0	0	0	0	0
Statutory rape	0	0	0	0	0	0	0	0	0
Robbery	0	0	0	0	0	0	0	0	0
Aggravated Assault	0	0	0	0	0	0	0	0	0
Burglary	0	0	0	0	0	0	0	0	0
Motor Vehicle Theft <i>*Does not include theft from motor vehicle</i>	0	0	0	0	0	0	0	0	0
Arson	0	0	0	0	0	0	0	0	0
Simple assault	0	0	0	0	0	0	0	0	0
Larceny-theft	0	0	0	0	0	0	0	0	0
Intimidation	0	0	0	0	0	0	0	0	0
Destruction/damage/ vandalism of property	0	0	0	0	0	0	0	0	0

HATE CRIMES-NON-CAMPUS (cont.)

2021 TOTAL	2021 Total	Category of Bias for crimes reported in 2021							
CRIMINAL OFFENSE		Race	Religion	Sexual Orientation	Gender	Gender Identity	Disability	Ethnicity	National Origin
Murder/Non-neg. Manslaughter	0	0	0	0	0	0	0	0	0
Rape	0	0	0	0	0	0	0	0	0
Fondling	0	0	0	0	0	0	0	0	0
Incest	0	0	0	0	0	0	0	0	0
Statutory rape	0	0	0	0	0	0	0	0	0
Robbery	0	0	0	0	0	0	0	0	0
Aggravated Assault	0	0	0	0	0	0	0	0	0
Burglary	0	0	0	0	0	0	0	0	0
Motor Vehicle Theft <i>*Does not include theft from motor vehicle</i>	0	0	0	0	0	0	0	0	0
Arson	0	0	0	0	0	0	0	0	0
Simple assault	0	0	0	0	0	0	0	0	0
Larceny-theft	0	0	0	0	0	0	0	0	0
Intimidation	0	0	0	0	0	0	0	0	0
Destruction/damage/ vandalism of property	0	0	0	0	0	0	0	0	0

HATE CRIMES-NON-CAMPUS (cont.)

2022 TOTAL	2022 Total	Category of Bias for crimes reported in 2022							
CRIMINAL OFFENSE		Race	Religion	Sexual Orientation	Gender	Gender Identity	Disability	Ethnicity	National Origin
Murder/Non-neg. Manslaughter	0	0	0	0	0	0	0	0	0
Rape	0	0	0	0	0	0	0	0	0
Fondling	0	0	0	0	0	0	0	0	0
Incest	0	0	0	0	0	0	0	0	0
Statutory rape	0	0	0	0	0	0	0	0	0
Robbery	0	0	0	0	0	0	0	0	0
Aggravated Assault	0	0	0	0	0	0	0	0	0
Burglary	0	0	0	0	0	0	0	0	0
Motor Vehicle Theft <i>*Does not include theft from motor vehicle</i>	0	0	0	0	0	0	0	0	0
Arson	0	0	0	0	0	0	0	0	0
Simple assault	0	0	0	0	0	0	0	0	0
Larceny-theft	0	0	0	0	0	0	0	0	0
Intimidation	0	0	0	0	0	0	0	0	0
Destruction/damage/ vandalism of property	0	0	0	0	0	0	0	0	0

HATE CRIMES-NON-CAMPUS
END

HATE CRIMES

PUBLIC PROPERTY

Merced and BRC, 2020/2021/2022

HATE CRIMES-PUBLIC PROPERTY

2020 TOTAL	2020 Total	Category of Bias for crimes reported in 2020							
CRIMINAL OFFENSE		Race	Religion	Sexual Orientation	Gender	Gender Identity	Disability	Ethnicity	National Origin
Murder/Non-neg. Manslaughter	0	0	0	0	0	0	0	0	0
Rape	0	0	0	0	0	0	0	0	0
Fondling	0	0	0	0	0	0	0	0	0
Incest	0	0	0	0	0	0	0	0	0
Statutory rape	0	0	0	0	0	0	0	0	0
Robbery	0	0	0	0	0	0	0	0	0
Aggravated Assault	0	0	0	0	0	0	0	0	0
Burglary	0	0	0	0	0	0	0	0	0
Motor Vehicle Theft <i>*Does not include theft from motor vehicle</i>	0	0	0	0	0	0	0	0	0
Arson	0	0	0	0	0	0	0	0	0
Simple assault	0	0	0	0	0	0	0	0	0
Larceny-theft	0	0	0	0	0	0	0	0	0
Intimidation	0	0	0	0	0	0	0	0	0
Destruction/damage/ vandalism of property	0	0	0	0	0	0	0	0	0

HATE CRIME-PUBLIC PROPERTY (cont.)

2021 TOTAL	2021 Total	Category of Bias for crimes reported in 2021							
CRIMINAL OFFENSE		Race	Religion	Sexual Orientation	Gender	Gender Identity	Disability	Ethnicity	National Origin
Murder/Non-neg. Manslaughter	0	0	0	0	0	0	0	0	0
Rape	0	0	0	0	0	0	0	0	0
Fondling	0	0	0	0	0	0	0	0	0
Incest	0	0	0	0	0	0	0	0	0
Statutory rape	0	0	0	0	0	0	0	0	0
Robbery	0	0	0	0	0	0	0	0	0
Aggravated Assault	0	0	0	0	0	0	0	0	0
Burglary	0	0	0	0	0	0	0	0	0
Motor Vehicle Theft <i>*Does not include theft from motor vehicle</i>	0	0	0	0	0	0	0	0	0
Arson	0	0	0	0	0	0	0	0	0
Simple assault	0	0	0	0	0	0	0	0	0
Larceny-theft	0	0	0	0	0	0	0	0	0
Intimidation	0	0	0	0	0	0	0	0	0
Destruction/damage/ vandalism of property	0	0	0	0	0	0	0	0	0

HATE CRIME-PUBLIC PROPERTY (cont.)

2022 TOTAL	2022 Total	Category of Bias for crimes reported in 2022							
CRIMINAL OFFENSE		Race	Religion	Sexual Orientation	Gender	Gender Identity	Disability	Ethnicity	National Origin
Murder/Non-neg. Manslaughter	0	0	0	0	0	0	0	0	0
Rape	0	0	0	0	0	0	0	0	0
Fondling	0	0	0	0	0	0	0	0	0
Incest	0	0	0	0	0	0	0	0	0
Statutory rape	0	0	0	0	0	0	0	0	0
Robbery	0	0	0	0	0	0	0	0	0
Aggravated Assault	0	0	0	0	0	0	0	0	0
Burglary	0	0	0	0	0	0	0	0	0
Motor Vehicle Theft <i>*Does not include theft from motor vehicle</i>	0	0	0	0	0	0	0	0	0
Arson	0	0	0	0	0	0	0	0	0
Simple assault	0	0	0	0	0	0	0	0	0
Larceny-theft	0	0	0	0	0	0	0	0	0
Intimidation	0	0	0	0	0	0	0	0	0
Destruction/damage/ vandalism of property	0	0	0	0	0	0	0	0	0

HATE CRIME-PUBLIC PROPERTY
END

VAWA OFFENSES

Merced and BRC, 2020/2021/2022

VAWA OFFENSES-ON CAMPUS

The 2013 Violence Against Women Act (VAWA) amended the Jeanne Clery Act to afford additional rights to campus victims of sexual assault, domestic violence, dating violence, and stalking.

In 2014 the United States Department of Education issued final regulations for implementation of the changes to the Clery Act.

CRIME	On Campus			Non-Campus Property			Public Property		
	2020	2021	2022	2020	2021	2022	2020	2021	2022
Domestic Violence	0	0	0	0	0	0	0	0	0
Dating Violence	0	0	1	0	0	0	0	0	0
Stalking	0	0	0	0	0	0	0	0	0

VAWA OFFENSES
END

**SPECIAL CATEGORY
AND
DISCIPLINARY ACTIONS**

Merced and BRC, 2020/2021/2022

SPECIAL CATEGORY ARRESTS (Liquor, Drug, and Weapons)-ON CAMPUS

ARRESTS	On Campus			Non-Campus Property			Public Property		
	2020	2021	2022	2020	2021	2022	2020	2021	2022
Weapons: Carrying, possessing, etc.	0	0	0	0	0	0	0	0	0
Drug Abuse Violations	0	0	0	0	0	0	0	0	0
Liquor Law Violations	0	0	0	0	0	0	0	0	0

**Does not include violations of school policies*

Disciplinary Actions

Alleged offenses reported to and investigated by Merced College Authority officials. Alleged offenders are referred for disciplinary action but are not arrested.

Offenses do not include violations of school policies.

Liquor law violations do not include drunkenness or driving under the influence.

ARRESTS	On Campus		
	2020	2021	2022
Weapons: Carrying, possessing, etc.	0	0	0
Drug Abuse Violations	0	0	0
Liquor Law Violations	0	0	0

**Does not include disciplinary actions that are strictly for school policy violations.*

<p>SPECIAL CATEGORY ARRESTS END</p>

UNFOUNDED CRIMES

Merced and BRC, 2020/2021/2022

UNFOUNDED CRIMES

Of those crimes that occurred On Campus, on or in Non-Campus property or buildings, and on Public Property, enter the number of crimes that were unfounded.

The total number of unfounded crimes should include all criminal offenses, hate crimes, domestic violence, dating violence, or stalking incidents that have been unfounded. Arrests and disciplinary actions cannot be unfounded.

	Number		
	2020	2021	2022
Total Unfounded Crimes	0	0	0

UNFOUNDED CRIMES
END

CRIME STATISTICS:

Los Banos Campus & Welding Shop

CRIMINAL OFFENSES

Los Banos Campus & Welding Shop
2020/2021/2022

CRIMINAL OFFENSES

OFFENSE TYPE	On Campus			Non-Campus Property			Public Property		
	2020	2021	2022	2020	2021	2022	2020	2021	2022
Murder/Non-negligent manslaughter	0	0	0	0	0	0	0	0	0
Negligent manslaughter	0	0	0	0	0	0	0	0	0
Rape	0	0	0	0	0	0	0	0	0
Fondling	0	0	0	0	0	0	0	0	0
Incest	0	0	0	0	0	0	0	0	0
Statutory rape	0	0	0	0	0	0	0	0	0
Robbery	0	0	0	0	0	0	0	0	0
Aggravated assault	0	0	0	0	0	0	0	0	0
Burglary	0	0	0	0	0	0	0	0	0
Motor vehicle theft <i>*Does not include theft from a motor vehicle</i>	0	0	0	0	0	0	0	0	0
Arson	0	0	0	0	0	0	0	0	0

CRIMINAL OFFENSES
 END

HATE CRIMES

ON CAMPUS

Los Banos Campus & Welding Shop

2020/2021/2022

HATE CRIMES-ON CAMPUS

2020 TOTAL	2020 Total	Category of Bias for crimes reported in 2020							
CRIMINAL OFFENSE		Race	Religion	Sexual Orientation	Gender	Gender Identity	Disability	Ethnicity	National Origin
Murder/Non-neg. Manslaughter	0	0	0	0	0	0	0	0	0
Rape	0	0	0	0	0	0	0	0	0
Fondling	0	0	0	0	0	0	0	0	0
Incest	0	0	0	0	0	0	0	0	0
Statutory rape	0	0	0	0	0	0	0	0	0
Robbery	0	0	0	0	0	0	0	0	0
Aggravated Assault	0	0	0	0	0	0	0	0	0
Burglary	0	0	0	0	0	0	0	0	0
Motor Vehicle Theft <i>*Does not include theft from motor vehicle</i>	0	0	0	0	0	0	0	0	0
Arson	0	0	0	0	0	0	0	0	0
Simple assault	0	0	0	0	0	0	0	0	0
Larceny-theft	0	0	0	0	0	0	0	0	0
Intimidation	0	0	0	0	0	0	0	0	0
Destruction/damage/ vandalism of property	0	0	0	0	0	0	0	0	0

HATE CRIMES-ON CAMPUS (cont.)

2021 TOTAL	2021 Total	Category of Bias for crimes reported in 2021							
CRIMINAL OFFENSE		Race	Religion	Sexual Orientation	Gender	Gender Identity	Disability	Ethnicity	National Origin
Murder/Non-neg. Manslaughter	0	0	0	0	0	0	0	0	0
Rape	0	0	0	0	0	0	0	0	0
Fondling	0	0	0	0	0	0	0	0	0
Incest	0	0	0	0	0	0	0	0	0
Statutory rape	0	0	0	0	0	0	0	0	0
Robbery	0	0	0	0	0	0	0	0	0
Aggravated Assault	0	0	0	0	0	0	0	0	0
Burglary	0	0	0	0	0	0	0	0	0
Motor Vehicle Theft <i>*Does not include theft from motor vehicle</i>	0	0	0	0	0	0	0	0	0
Arson	0	0	0	0	0	0	0	0	0
Simple assault	0	0	0	0	0	0	0	0	0
Larceny-theft	0	0	0	0	0	0	0	0	0
Intimidation	0	0	0	0	0	0	0	0	0
Destruction/damage/ vandalism of property	0	0	0	0	0	0	0	0	0

HATE CRIMES-ON CAMPUS (cont.)

2022 TOTAL	2022 Total	Category of Bias for crimes reported in 2022							
CRIMINAL OFFENSE		Race	Religion	Sexual Orientation	Gender	Gender Identity	Disability	Ethnicity	National Origin
Murder/Non-neg. Manslaughter	0	0	0	0	0	0	0	0	0
Rape	0	0	0	0	0	0	0	0	0
Fondling	0	0	0	0	0	0	0	0	0
Incest	0	0	0	0	0	0	0	0	0
Statutory rape	0	0	0	0	0	0	0	0	0
Robbery	0	0	0	0	0	0	0	0	0
Aggravated Assault	0	0	0	0	0	0	0	0	0
Burglary	0	0	0	0	0	0	0	0	0
Motor Vehicle Theft <i>*Does not include theft from motor vehicle</i>	0	0	0	0	0	0	0	0	0
Arson	0	0	0	0	0	0	0	0	0
Simple assault	0	0	0	0	0	0	0	0	0
Larceny-theft	0	0	0	0	0	0	0	0	0
Intimidation	0	0	0	0	0	0	0	0	0
Destruction/damage/ vandalism of property	0	0	0	0	0	0	0	0	0

HATE CRIMES-ON CAMPUS
END

HATE CRIMES

PUBLIC PROPERTY

Los Banos Campus & Welding Shop

2020/2021/2022

HATE CRIMES-PUBLIC PROPERTY

2020 TOTAL	2020 Total	Category of Bias for crimes reported in 2020							
CRIMINAL OFFENSE		Race	Religion	Sexual Orientation	Gender	Gender Identity	Disability	Ethnicity	National Origin
Murder/Non-neg. Manslaughter	0	0	0	0	0	0	0	0	0
Rape	0	0	0	0	0	0	0	0	0
Fondling	0	0	0	0	0	0	0	0	0
Incest	0	0	0	0	0	0	0	0	0
Statutory rape	0	0	0	0	0	0	0	0	0
Robbery	0	0	0	0	0	0	0	0	0
Aggravated Assault	0	0	0	0	0	0	0	0	0
Burglary	0	0	0	0	0	0	0	0	0
Motor Vehicle Theft <i>*Does not include theft from motor vehicle</i>	0	0	0	0	0	0	0	0	0
Arson	0	0	0	0	0	0	0	0	0
Simple assault	0	0	0	0	0	0	0	0	0
Larceny-theft	0	0	0	0	0	0	0	0	0
Intimidation	0	0	0	0	0	0	0	0	0
Destruction/damage/ vandalism of property	0	0	0	0	0	0	0	0	0

HATE CRIME-PUBLIC PROPERTY (cont.)

2021 TOTAL	2021 Total	Category of Bias for crimes reported in 2021							
CRIMINAL OFFENSE		Race	Religion	Sexual Orientation	Gender	Gender Identity	Disability	Ethnicity	National Origin
Murder/Non-neg. Manslaughter	0	0	0	0	0	0	0	0	0
Rape	0	0	0	0	0	0	0	0	0
Fondling	0	0	0	0	0	0	0	0	0
Incest	0	0	0	0	0	0	0	0	0
Statutory rape	0	0	0	0	0	0	0	0	0
Robbery	0	0	0	0	0	0	0	0	0
Aggravated Assault	0	0	0	0	0	0	0	0	0
Burglary	0	0	0	0	0	0	0	0	0
Motor Vehicle Theft <i>*Does not include theft from motor vehicle</i>	0	0	0	0	0	0	0	0	0
Arson	0	0	0	0	0	0	0	0	0
Simple assault	0	0	0	0	0	0	0	0	0
Larceny-theft	0	0	0	0	0	0	0	0	0
Intimidation	0	0	0	0	0	0	0	0	0
Destruction/damage/ vandalism of property	0	0	0	0	0	0	0	0	0

HATE CRIME-PUBLIC PROPERTY (cont.)

2022 TOTAL	2022 Total	Category of Bias for crimes reported in 2022							
CRIMINAL OFFENSE		Race	Religion	Sexual Orientation	Gender	Gender Identity	Disability	Ethnicity	National Origin
Murder/Non-neg. Manslaughter	0	0	0	0	0	0	0	0	0
Rape	0	0	0	0	0	0	0	0	0
Fondling	0	0	0	0	0	0	0	0	0
Incest	0	0	0	0	0	0	0	0	0
Statutory rape	0	0	0	0	0	0	0	0	0
Robbery	0	0	0	0	0	0	0	0	0
Aggravated Assault	0	0	0	0	0	0	0	0	0
Burglary	0	0	0	0	0	0	0	0	0
Motor Vehicle Theft <i>*Does not include theft from motor vehicle</i>	0	0	0	0	0	0	0	0	0
Arson	0	0	0	0	0	0	0	0	0
Simple assault	0	0	0	0	0	0	0	0	0
Larceny-theft	0	0	0	0	0	0	0	0	0
Intimidation	0	0	0	0	0	0	0	0	0
Destruction/damage/ vandalism of property	0	0	0	0	0	0	0	0	0

HATE CRIME-PUBLIC PROPERTY
END

VAWA OFFENSES

Los Banos Campus & Welding Shop
2020/2021/2022

VAWA OFFENSES-ON CAMPUS

The 2013 Violence Against Women Act (VAWA) amended the Jeanne Clery Act to afford additional rights to campus victims of sexual assault, domestic violence, dating violence, and stalking.

In 2014 the United States Department of Education issued final regulations for implementation of the changes to the Clery Act.

CRIME	On Campus			Non-Campus Property			Public Property		
	2020	2021	2022	2020	2021	2022	2020	2021	2022
Domestic Violence	0	0	0	0	0	0	0	0	0
Dating Violence	0	0	0	0	0	0	0	0	0
Stalking	0	0	0	0	0	0	0	0	0

VAWA OFFENSES
END

**SPECIAL CATEGORY
AND
DISCIPLINARY ACTIONS**

Los Banos Campus & Welding Shop
2020/2021/2022

SPECIAL CATEGORY ARRESTS (Liquor, Drug, and Weapons)

ARRESTS	On Campus			Non-Campus Property			Public Property		
	2020	2021	2022	2020	2021	2022	2020	2021	2022
Weapons: Carrying, possession, etc.	0	0	0	0	0	0	0	0	0
Drug Abuse Violations	0	0	0	0	0	0	0	0	0
Liquor Law Violations	0	0	0	0	0	0	0	0	0

Does not include violations of school policies

Disciplinary Actions

Alleged offenses reported to and investigated by Merced College Authority officials. Alleged offenders are referred for disciplinary action but are not arrested.

**Offenses do not include violations of school policies.
Liquor law violations do not include drunkenness or driving under the influence.**

ARRESTS	On Campus		
	2020	2021	2022
Liquor Laws	0	0	0
Drug Violations	0	0	0
Weapons Possession	0	0	0

Does not include disciplinary actions that are strictly for school policy violations.

<p>SPECIAL CATEGORY ARRESTS END</p>

UNFOUNDED CRIMES

Los Banos Campus & Welding Shop
2020/2021/2022

UNFOUNDED CRIMES

Of those crimes that occurred On Campus, on or in Non-Campus property or buildings, and on Public Property, enter the number of crimes that were unfounded.

The total number of unfounded crimes should include all criminal offenses, hate crimes, domestic violence, dating violence, or stalking incidents that have been unfounded. Arrests and disciplinary actions cannot be unfounded.

	Number		
	2020	2021	2022
Total Unfounded Crimes	0	0	0

UNFOUNDED CRIMES
END

Merced Community College District Area Map

A. Merced Campus

3600 M Street, Merced, CA 95340

B. Business Resource Center (BRC)

630 W. 19th Street, Merced, CA 95348

C. Los Banos Campus

22240 Highway 152, Los Banos, CA 93635

D. Welding Shop (LB)

60 G Street, Suite A, Los Banos, CA 93635

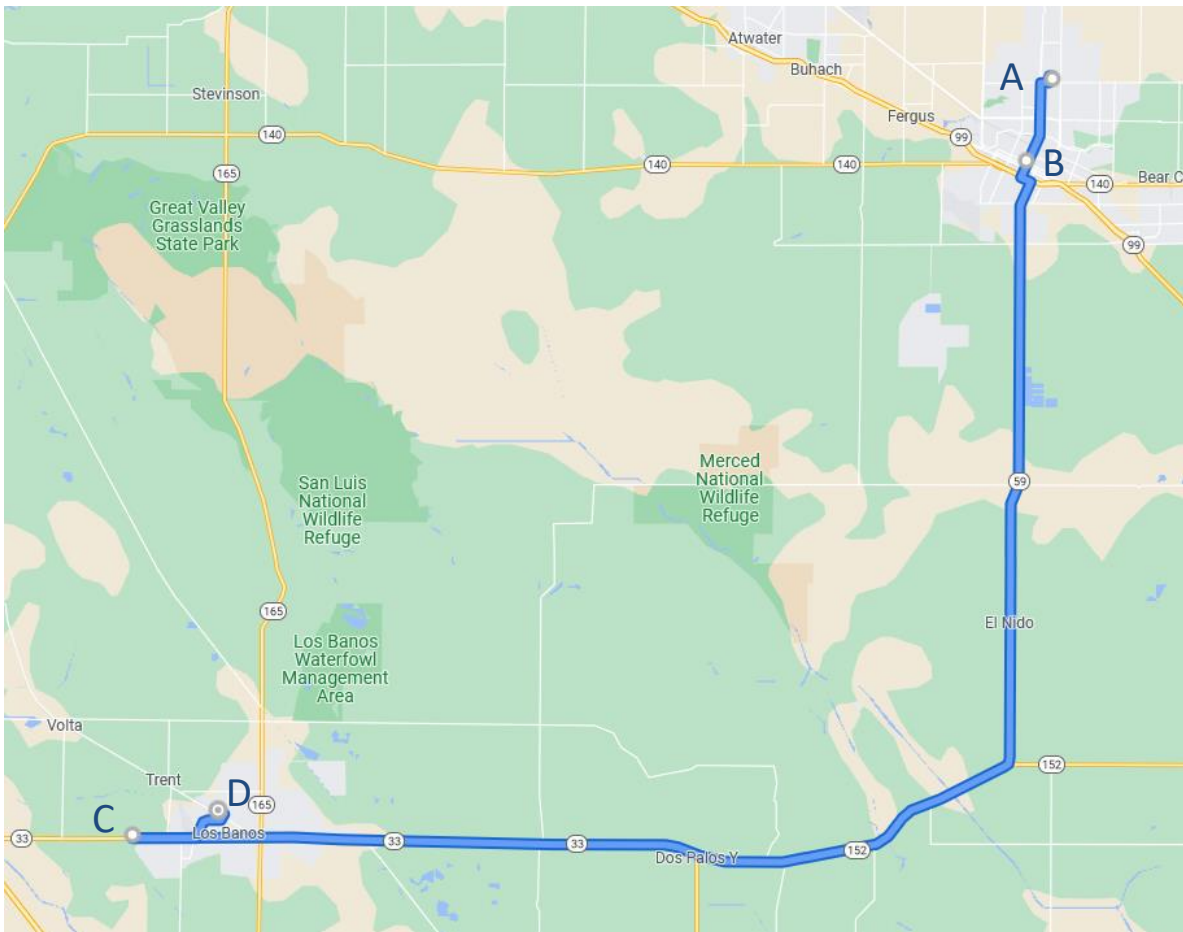

Merced Campus

3600 M Street

Merced, CA 95348

<https://www.mccd.edu/wp-content/uploads/2023/03/Merced-Campus-Map-Print-202207-v7.pdf>

“STUDENTS ARE OUR FOCUS AND WE ARE KNOWN BY THEIR SUCCESS”

3600 M Street, Merced, CA 95348 www.mccd.edu (209) 384-6000 Emergency: (209) 386-6600



CAMPUS MAP SYMBOLS

- = Accessible Bus Stop
- = Accessible Parking
- = Bicycle Parking
- = Campus Police
- = Code Blue Emergency Phone
- = Electric Vehicle Charging Section
- = Food Services
- = Health Services
- = Map
- = Parking Dispensers
- = Parking Lot
- = Pedestrian Pathway
- = Visitor / Short-term Parking
- = Bookstore

MERCED COLLEGE CAMPUS BUILDINGS

- ADMIN Administration Building
- AG Agriculture Building
- AG/IT Raj Kahlon Agriculture and Industrial Technology Complex
- AGP Agriculture Pavilion and Barns
- AHC Dr. Lakireddy School of Health Sciences–Allied Health
- ART Art Building
- CDC Child Development Center
- DLRC Downey Learning Resource Center
- FH Fieldhouses:
 - A - Pool, Training Room and Fitness Lab (FHA)
 - B - Butch Hughes Clubhouse
 - C - Football
- GYM Gymnasium
- IAC Bizzini Interdisciplinary Academic Center:
 - Building A - Social Science
 - Building B - Rising Scholars and IAC 139
 - Building C - Humanities
- LES Lesher Student Services Center
- MA Mechanized Agriculture
- MUS Music Building
- OP Purchasing, Capital Planning, Custodial, Maintenance, Grounds and Transportation
- PD Campus Police
- PS Plant Science
- PSC Public Safety Complex
- SB Service Building
- SCI Science Building
- SLR Softball Locker Room
- STU Student Union
- TIC Trident Innovation Center
- THTR Theater Building
- VOC Vocational Building
- WAT Welding & Automotive Technology

Los Banos

22240 Highway 152
Los Banos, CA 93635

<https://www.mccd.edu/wp-content/uploads/2022/11/los-banos-campus-map.pdf>

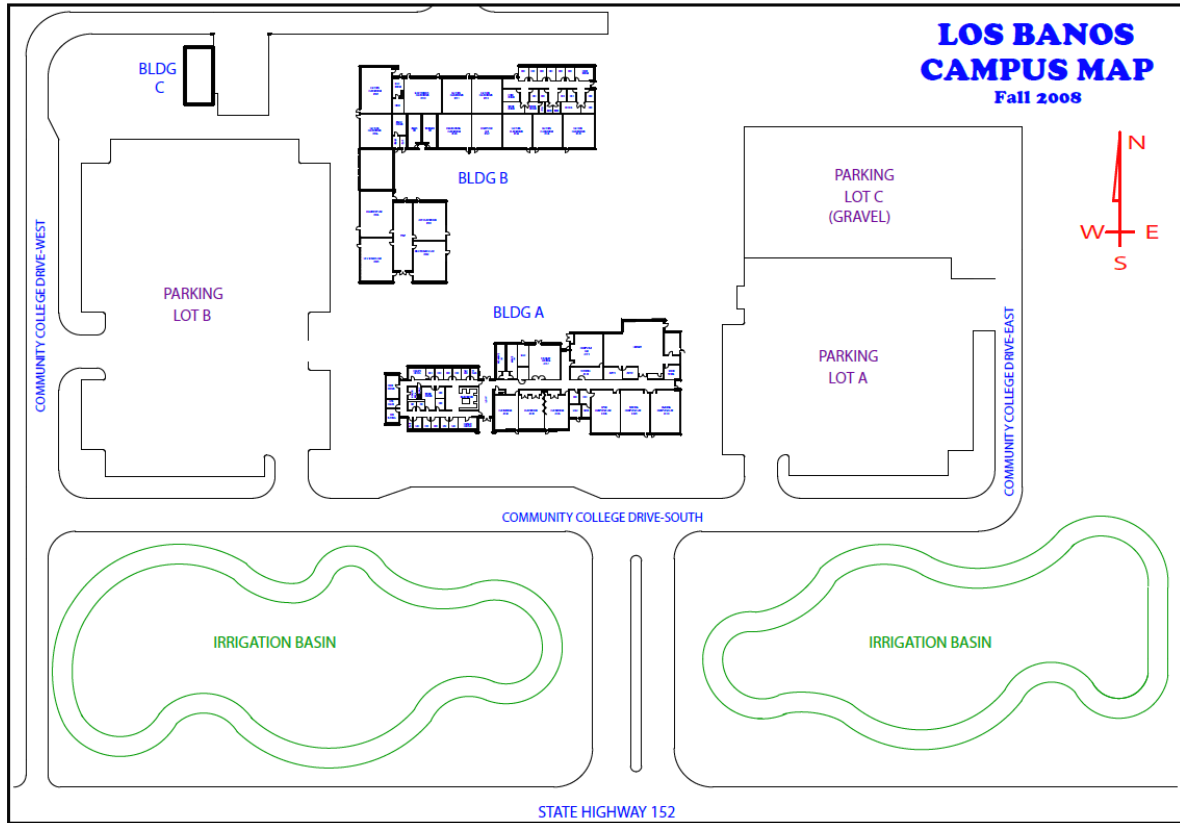

**MERCED COMMUNITY COLLEGE DISTRICT
CAMPUS POLICE SERVICES**

If you have any questions, comments, or concerns regarding any of the materials covered in this booklet, please contact the Merced College Campus Police Department at (209) 386-6600 or email campuspolice@mccd.edu.

You may also stop by our main office at:

3600 M Street, Public Safety Complex 4 in Merced, CA 95340.

END OF REPORT